

HAROLD STREET NORTH

SLOCAN, BC

ISSUED FOR TENDER: LANDSCAPE PLAN

DRAWING LIST:

- L1.0 LANDSCAPE PLAN
- L1.1 LANDSCAPE PLAN
- L1.2 LANDSCAPE PLAN
- L1.3 PLANT SCHEDULE
- L2.0 LANDSCAPE DETAILS
- L2.1 LANDSCAPE DETAILS
- L2.2 LANDSCAPE DETAILS
- L2.3 LANDSCAPE DETAILS
- L2.4 LANDSCAPE DETAILS

2026.03.16



SUBMITTED TO:

Village of Slocan
Planning + Development
503 Slocan Street
Slocan, BC
PO Box 50 V0G 2C0



LAWSON
— ENGINEERING LTD. —

LARCH LANDSCAPE ARCHITECTURE

Box 1738
Golden, BC V0A 1H0
T: (250) 938-7337
E: larchlandscapearchitecture@gmail.com
www.larchlandscapearchitecture.com



Any reuse, modification, or alteration of this document and the ideas and designs incorporated herein is at the sole risk of the party(ies) reusing, modifying, or altering it. All references to Larch Landscape + Authentic Mountain Design and their employees and all professional seals shall be removed prior to any reuse, modification or alteration to this document.

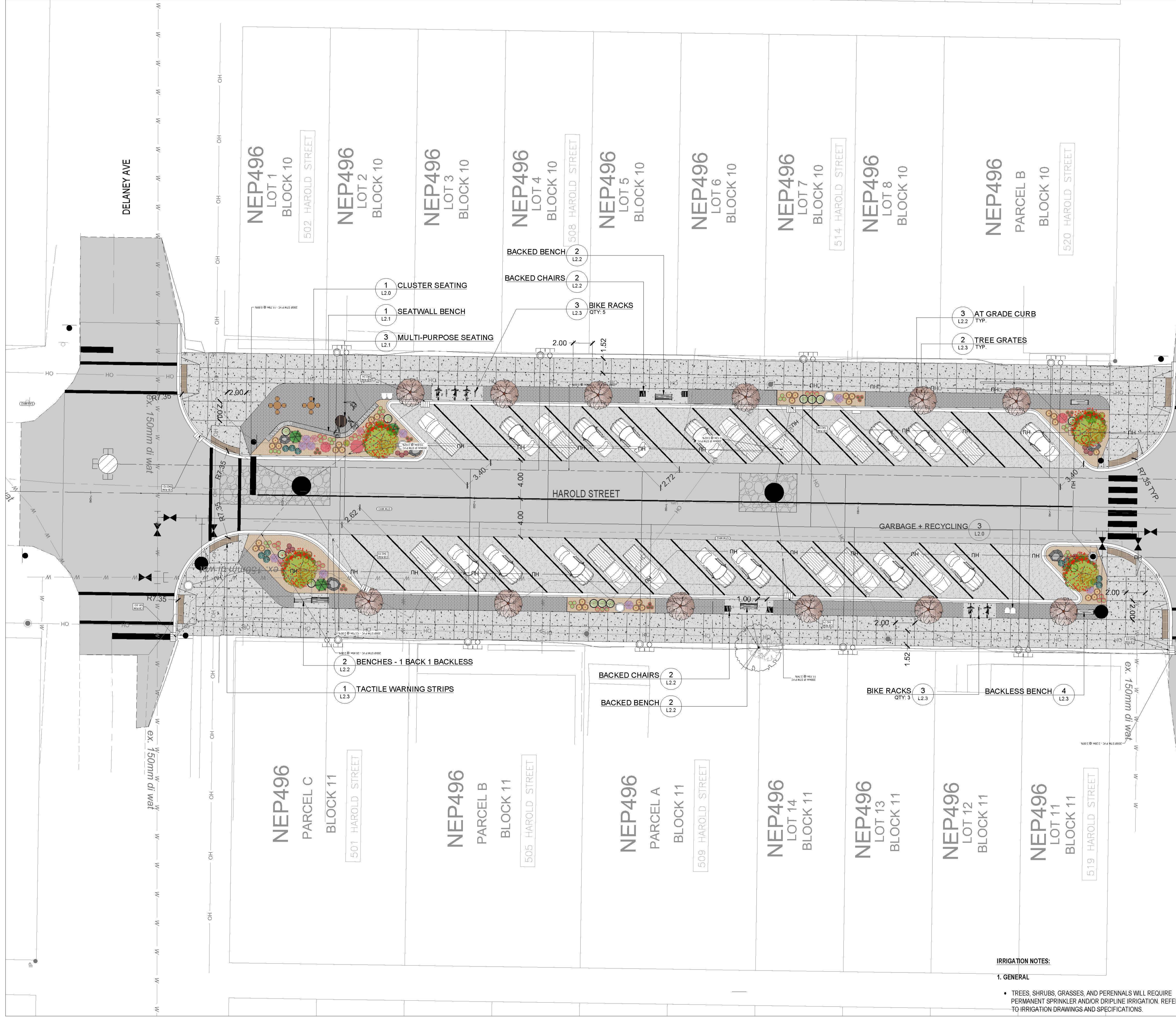

LEGEND

- EXISTING/PROPOSED UNDERGROUND UTILITIES PER CIVIL
- EXISTING/OVERHEAD UTILITIES PER SURVEY
- PROPOSED VEGETATION REFER TO PLANT SCHEDULE
- CONCRETE PAVING WITH MEDIUM BROOM FINISH WITH SAWCUT JOINTS APPROX. AREA: 815m² (8,772 ft²)
- PROPOSED ASPHALT PAVING PER CIVIL
- PROPOSED CONCRETE PAVING STONES - TECHNO BLOCK LINEA IN PER DETAIL 1, L2.2 QTY: 235m² (2,539 ft²)
- PROPOSED COURSE CEDAR BARK MULCH NATURAL COLOUR OR 20mm ANGULAR CHARCOAL ROCK MULCH 75mm (3" DEPTH) WITH TYPAR GEOTEXTILE FABRIC APPROX. AREA: 180m² (1,940 ft²)
- FEATURE Boulders (5) - LOCAL STONE APPROX. 500mm HT x 1000mm L x 500mm W BURIED APPROX. 150mm DEPTH

- GENERAL NOTES:**
- CONTRACTOR TO LOCATE AND PROTECT ALL EXISTING UTILITIES AND SERVICES, BC ONE CALL 1-800-474-6886.
 - ALL WORK AND MATERIALS ARE TO BE IN ACCORDANCE WITH THE CURRENT EDITIONS OF THE VILLAGE OF SLOCAN CONSTRUCTION STANDARDS, AND THE MASTER MUNICIPAL CONSTRUCTION DOCUMENTS (MMCD) REQUIREMENTS.
 - CONTRACTOR SHALL VERIFY SITE CONDITIONS PRIOR TO DEMOLITION OR CONSTRUCTION.
 - CONTRACTOR TO VERIFY ALL DIMENSIONS AND REPORT ANY DISCREPANCIES TO ENGINEER OR LANDSCAPE ARCHITECT. PROPERTY LINES TO BE VERIFIED PRIOR TO CONSTRUCTION.
 - CONTRACTOR IS RESPONSIBLE TO COORDINATE THE STAGING OF CONSTRUCTION ACTIVITIES AND WORK WITH ALL OTHER CONTRACTORS ON SITE, INCLUDING IRRIGATION SLEEVING AND WEeping TILE DOWNSPOUT LOCATIONS PRIOR TO HARDSCAPE INSTALLATION.
 - THE LANDSCAPE ARCHITECT WILL BE NOTIFIED MIN. 48 HOURS PRIOR TO COMMENCEMENT OF WORK.
 - THE QUANTITIES LISTED ARE ESTIMATES. CONTRACTOR TO VERIFY ALL QUANTITIES THROUGH SITE SURVEY AND REPORT ANY DISCREPANCIES TO ENGINEER OR LANDSCAPE ARCHITECT.
 - ANY CHANGES OR ALTERATIONS TO DRAWINGS SHALL BE APPROVED BY LANDSCAPE ARCHITECT.
 - CONTRACTOR TO CONFIRM ELEVATION, LOCATION, AND GRADIENT OF SURROUNDING GRADES AND PROVIDE A SMOOTH TRANSITION.
 - CONTRACTOR TO BE REGISTERED WITH WORKSAFE BC.

- PLANTING NOTES:**
- REFER TO PLANT SCHEDULE FOR DETAILED SPECIES INFORMATION L1.2. NO PLANT SUBSTITUTIONS ARE PERMITTED WITHOUT WRITTEN APPROVAL BY LANDSCAPE ARCHITECT.
 - CONFINE EQUIPMENT AND WORKERS TO LIMIT OF DISTURBANCE WITHIN PHASE I BOUNDARY.
 - TURF TO BE PLANTED ADJACENT TO DISTURBED AREAS AND OTHER AREAS OF NEW CONSTRUCTION.
 - PLANT MATERIAL SHALL MEET ALL REQUIREMENTS OF THE LATEST EDITION OF THE CANADIAN NURSERY TRADES ASSOCIATION GUIDE SPECIFICATIONS FOR NURSERY STOCK UNLESS OTHERWISE SPECIFIED.
 - SUPPLY 75mm OF NATURAL COLOUR CEDAR BARK MULCH OR ANGULAR ROCK MULCH TO ALL PROPOSED TREE AND SHRUB BEDS.
 - INSTALL 600-1000mm MIN. DEPTH TOPSOIL IN PLANTING AREAS.
 - TREES AND SHRUBS TO BE GUARANTEED FOR 2 GROWING SEASONS BY CONTRACTOR. ALL REPLACEMENTS TO BE AT CONTRACTOR'S EXPENSE. SUBSTITUTIONS TO BE APPROVED BY LANDSCAPE ARCHITECT.

- TOPSOIL NOTES:**
- GROWING MEDIUM FOR ALL TREE, SHRUB, AND WILDFLOWER BEDS IS TO MEET THE CANADIAN LANDSCAPE SPECIFICATION UNDER THE DESIGNATION 2P.
 - GROWING MEDIUM SHOULD BE CERTIFIED TO ITS ORIGIN AND VIRTUALLY FREE OF INVASIVE PLANT SEEDS, THEIR REPRODUCTIVE PARTS AND ROOTS, BUILDING MATERIALS, INVASIVE OR NOXIOUS PLANTS, NON-COMPOSTED WOOD, WOOD WASTE, INSECT PESTS, PLANT PATHOGENIC ORGANISMS, CHEMICAL POLLUTANTS OR SUBSTANCES AT LEVELS TOXIC TO PLANTS, AND OTHER EXTRANEANOUS MATERIALS THAT DETRACT FROM DESIRABLE PHYSICAL AND CHEMICAL PROPERTIES REQUIRED FOR LANDSCAPING PURPOSES.

- LOAM: NATURAL, FERTILE, FRIABLE, AGRICULTURAL SOIL MEETING FOLLOWING REQUIREMENTS:
- NOT LESS THAN 6% ORGANIC MATERIAL.
 - PH VALUE RANGING FROM 5.9 TO 7.0.
 - NON-TOXIC TO PLANT GROWTH.
 - E.C. SALINITY READING NOT EXCEEDING 1.5.
 - SOIL TEXTURE: LOAM SOIL AS DEFINED BY CANADIAN SYSTEM OF SOIL CLASSIFICATION.

- PEAT MOSS: DECOMPOSED PLANT MATERIAL, FAIRLY ELASTIC AND HOMOGENEOUS, FREE OF DECOMPOSED COLLOIDAL RESIDUE, WOOD, SULPHUR, AND IRON. MINIMUM OF 80% ORGANIC MATTER BY MASS; PH VALUE BETWEEN 4.5 AND 6.0.

- IRRIGATION NOTES:**
- GENERAL
 - TREES, SHRUBS, GRASSES, AND PERENNIALS WILL REQUIRE PERMANENT SPRINKLER AND/OR DRIP IRRIGATION. REFER TO IRRIGATION DRAWINGS AND SPECIFICATIONS.

PROJECT:
HAROLD STREET NORTH RECONSTRUCTION

LOCATION:
SLOCAN, BC

LEGAL DESCRIPTION:
LOT A, PLAN NEP20184



CLIENT: VILLAGE OF SLOCAN
T: 250.355.2277
E: admin@villageofslocan.ca

LANDSCAPE ARCHITECT: BCSLA 563



GOLDEN, BC 250.938.7337

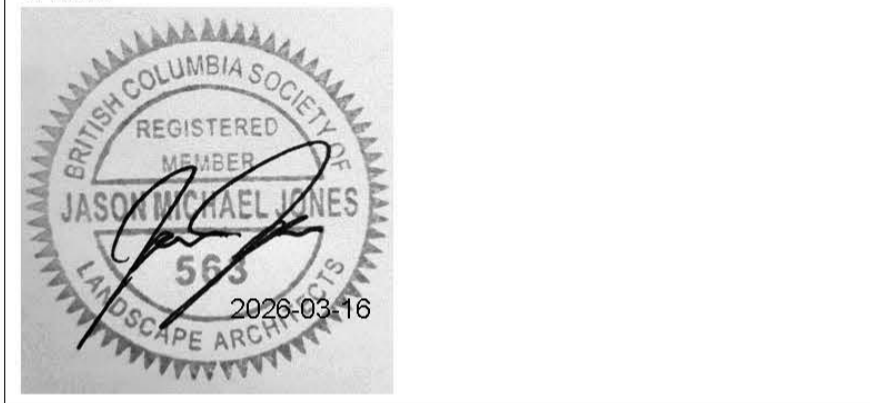

CIVIL ENGINEER:
LAWSON ENGINEERING LTD.

825C LAKESHORE DRIVE W
PO BOX 106 SALMON ARM, BC V1E 4N2
T: 250.832-3220

NOTE: ORIGINAL SIZE ANSI D (22x34")

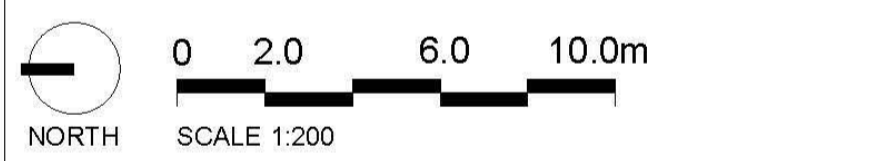

ISSUED FOR: TENDER

DATE: 2026-03-16

NOT FOR CONSTRUCTION

REVISIONS:	NO.	DESCRIPTION	DATE	BY:
	1.	PRELIMINARY DESIGN	2022-10-27	JJ
	2.	50% REVIEW	2022-11-09	JJ
	3.	75% REVIEW	2022-12-05	JJ
	4.	100% REVIEW	2023-01-31	JJ
	5.	ISSUED FOR TENDER	2023-02-15	JJ
	6.	RE-ISSUED FOR TENDER REVIEW	2025-12-11	JJ
	7.	ISSUED FOR TENDER	2026-03-16	JJ

DESIGNED BY: JJ

DRAWING TITLE:
LANDSCAPE SITE PLAN

L-1.0

Any reuse, modification, or alteration of this document and the ideas and designs incorporated herein is at the sole risk of the party(ies) reusing, modifying, or altering it. All references to Larch Landscape + Authentic Mountain Design and their employees and all professional seals shall be removed prior to any reuse, modification or alteration to this document.

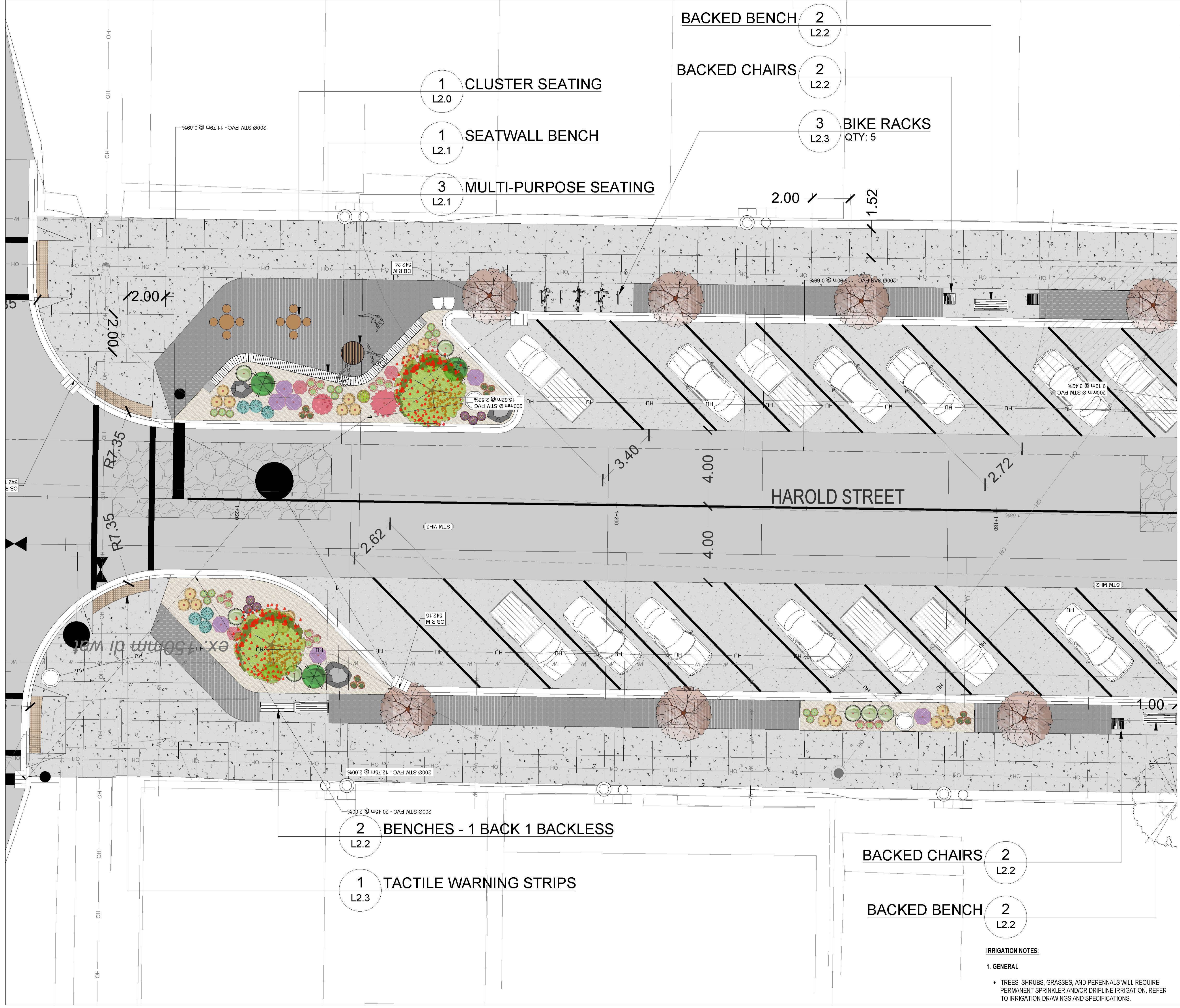

LEGEND

- EXISTING/PROPOSED UNDERGROUND UTILITIES PER CIVIL
- EXISTING OVERHEAD UTILITIES PER SURVEY
- PROPOSED VEGETATION REFER TO PLANT SCHEDULE
- CONCRETE PAVING WITH MEDIUM BROOM FINISH WITH SAWCUT JOINTS APPROX. AREA: 815m² (8,772 ft²)
- PROPOSED ASPHALT PAVING PER CIVIL
- PROPOSED CONCRETE PAVING STONES - TECHNO BLOCK LINE IN PER DETAIL 1, L2.2 QTY: 235m² (2,530 ft²)
- PROPOSED COURSE CEDAR BARK MULCH NATURAL COLOUR OR 20mm ANGULAR CHARCOAL ROCK MULCH 75mm (3" DEPTH) WITH TYPPAR GEOTEXTILE FABRIC APPROX. AREA: 180m² (1,940 ft²)
- FEATURE BOULDERS (5) - LOCAL STONE APPROX. 500mm HT x 1000mm L x 500mm W BURIED APPROX. 150mm DEPTH

- GENERAL NOTES:**
- CONTRACTOR TO LOCATE AND PROTECT ALL EXISTING UTILITIES AND SERVICES, BC ONE CALL 1-800-474-6886.
 - ALL WORK AND MATERIALS ARE TO BE IN ACCORDANCE WITH THE CURRENT EDITIONS OF THE VILLAGE OF SLOCAN CONSTRUCTION STANDARDS, AND THE MASTER MUNICIPAL CONSTRUCTION DOCUMENTS (MPCD) REQUIREMENTS.
 - CONTRACTOR SHALL VERIFY SITE CONDITIONS PRIOR TO DEMOLITION OR CONSTRUCTION.
 - CONTRACTOR TO VERIFY ALL DIMENSIONS AND REPORT ANY DISCREPANCIES TO ENGINEER OR LANDSCAPE ARCHITECT. PROPERTY LINES TO BE VERIFIED PRIOR TO CONSTRUCTION.
 - CONTRACTOR IS RESPONSIBLE TO COORDINATE THE STAGING OF CONSTRUCTION ACTIVITIES AND WORK WITH ALL OTHER CONTRACTORS ON-SITE, INCLUDING IRRIGATION SLEEVING AND WEeping TIE DOWNSPOUT LOCATIONS PRIOR TO HARDSCAPE INSTALLATION.
 - THE LANDSCAPE ARCHITECT WILL BE NOTIFIED MIN. 48 HOURS PRIOR TO COMMENCEMENT OF WORK.
 - THE QUANTITIES LISTED ARE ESTIMATES. CONTRACTOR TO VERIFY ALL QUANTITIES THROUGH SITE SURVEY AND REPORT ANY DISCREPANCIES TO ENGINEER OR LANDSCAPE ARCHITECT.
 - ANY CHANGES OR ALTERATIONS TO DRAWINGS SHALL BE APPROVED BY LANDSCAPE ARCHITECT.
 - CONTRACTOR TO CONFIRM ELEVATION, LOCATION, AND GRADIENT OF SURROUNDING GRADES AND PROVIDE A SMOOTH TRANSITION.
 - CONTRACTOR TO BE REGISTERED WITH WORKSAFE BC.

- PLANTING NOTES:**
- REFER TO PLANT SCHEDULE FOR DETAILED SPECIES INFORMATION L1.2. NO PLANT SUBSTITUTIONS ARE PERMITTED WITHOUT WRITTEN APPROVAL BY LANDSCAPE ARCHITECT.
 - CONFINE EQUIPMENT AND WORKERS TO LIMIT OF DISTURBANCE WITHIN PHASE I BOUNDARY.
 - TURF TO BE PLANTED ADJACENT TO DISTURBED AREAS AND OTHER AREAS OF NEW CONSTRUCTION.
 - PLANT MATERIAL SHALL MEET ALL REQUIREMENTS OF THE LATEST EDITION OF THE CANADIAN NURSERY TRADES ASSOCIATION GUIDE SPECIFICATIONS FOR NURSERY STOCK UNLESS OTHERWISE SPECIFIED.
 - SUPPLY 75mm OF NATURAL COLOUR CEDAR BARK MULCH OR ANGULAR ROCK MULCH TO ALL PROPOSED TREE AND SHRUB BEDS.
 - INSTALL 600-1000mm MIN. DEPTH TOPSOIL IN PLANTING AREAS.
 - TREES AND SHRUBS TO BE GUARANTEED FOR 2 GROWING SEASONS BY CONTRACTOR. ALL REPLACEMENTS TO BE AT CONTRACTOR'S EXPENSE. SUBSTITUTIONS TO BE APPROVED BY LANDSCAPE ARCHITECT.

- TOPSOIL NOTES:**
- GROWING MEDIUM FOR ALL TREE, SHRUB, AND WILDFLOWER BEDS IS TO MEET THE CANADIAN LANDSCAPE SPECIFICATION UNDER THE DESIGNATION 2P.
 - GROWING MEDIUM SHOULD BE CERTIFIED TO ITS ORIGIN AND VIRTUALLY FREE OF INVASIVE PLANT SEEDS, THEIR REPRODUCTIVE PARTS AND ROOTS, BUILDING MATERIALS, INVASIVE OR NOXIOUS PLANTS, NON-COMPOSTED WOOD, WOOD WASTE, INSECT PESTS, PLANT PATHOGENIC ORGANISMS, CHEMICAL POLLUTANTS OR SUBSTANCES AT LEVELS TOXIC TO PLANTS, AND OTHER EXTRANEUS MATERIALS THAT DETRACT FROM DESIRABLE PHYSICAL AND CHEMICAL PROPERTIES REQUIRED FOR LANDSCAPING PURPOSES.

- LOAM: NATURAL, FERTILE, FRIABLE, AGRICULTURAL SOIL MEETING FOLLOWING REQUIREMENTS:**
- NOT LESS THAN 6% ORGANIC MATERIAL.
 - PH VALUE RANGING FROM 5.9 TO 7.0.
 - NON-TOXIC TO PLANT GROWTH.
 - E.C. SALINITY READING NOT EXCEEDING 1.5.
 - SOIL TEXTURE: LOAM SOIL AS DEFINED BY CANADIAN SYSTEM OF SOIL CLASSIFICATION.
- PEAT MOSS: DECOMPOSED PLANT MATERIAL, FAIRLY ELASTIC AND HOMOGENEOUS, FREE OF DECOMPOSED COLLOIDAL RESIDUE, WOOD, SULPHUR, AND IRON. MINIMUM OF 80% ORGANIC MATTER BY MASS; PH VALUE BETWEEN 4.5 AND 6.0.**

- IRRIGATION NOTES:**
- GENERAL**
 - TREES, SHRUBS, GRASSES, AND PERENNIALS WILL REQUIRE PERMANENT SPRINKLER AND/OR DRIPLINE IRRIGATION. REFER TO IRRIGATION DRAWINGS AND SPECIFICATIONS.

PROJECT:
HAROLD STREET NORTH RECONSTRUCTION

LOCATION:
SLOCAN, BC

LEGAL DESCRIPTION:
LOT A, PLAN NEP20184



CLIENT:
VILLAGE OF SLOCAN

T: 250.355.2277
E: admin@villageofslocan.ca

LANDSCAPE ARCHITECT BCSLA 563



GOLDEN, BC 250.938.7337

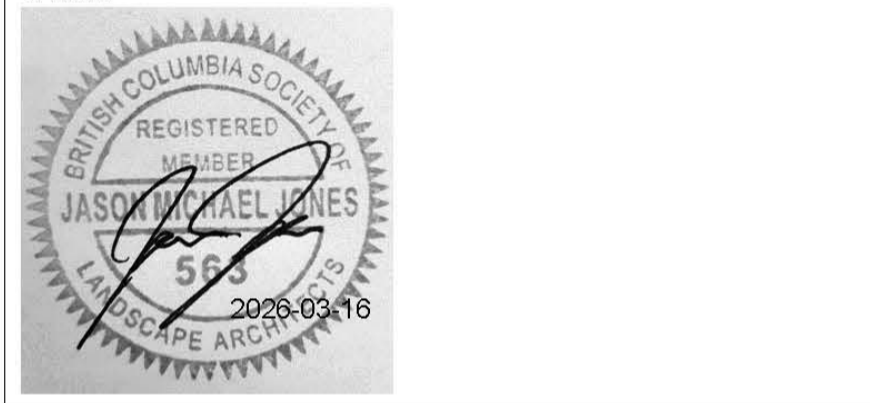

825C LAKESHORE DRIVE W
PO BOX 106 SALMON ARM, BC V1E 4N2
T: 250.832-3220

NOTE: ORIGINAL SIZE ANSI D (22x34")

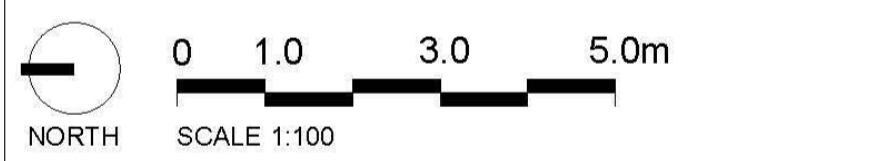

ISSUED FOR: TENDER

DATE: 2026-03-16

NOT FOR CONSTRUCTION

NO.	DESCRIPTION	DATE	BY
1.	PRELIMINARY DESIGN	2022-10-27	JJ
2.	50% REVIEW	2022-11-09	JJ
3.	75% REVIEW	2022-12-05	JJ
4.	100% REVIEW	2023-01-31	JJ
5.	ISSUED FOR TENDER	2023-02-15	JJ
6.	RE-ISSUED FOR TENDER REVIEW	2025-12-11	JJ
7.	ISSUED FOR TENDER	2026-03-16	JJ

DESIGNED BY: JJ

DRAWING TITLE:
LANDSCAPE PLAN

L-1.1

Any reuse, modification, or alteration of this document and the ideas and designs incorporated herein is at the sole risk of the party(ies) reusing, modifying, or altering it. All references to Larch Landscape + Authentic Mountain Design and their employees and all professional seals shall be removed prior to any reuse, modification or alteration to this document.

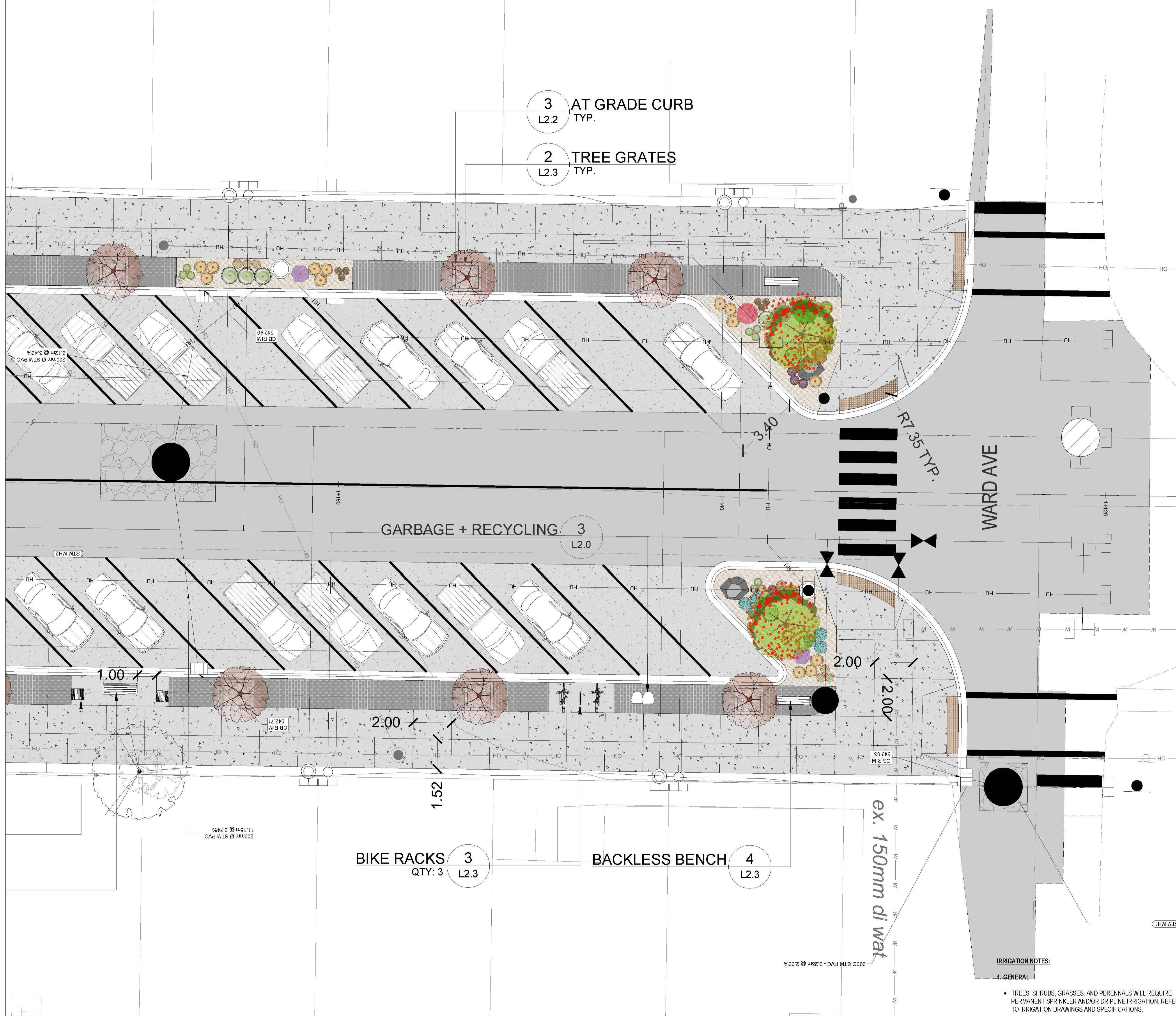

- LEGEND**
- EXISTING/PROPOSED UNDERGROUND UTILITIES PER CIVIL
 - EXISTING OVERHEAD UTILITIES PER SURVEY
 - PROPOSED VEGETATION REFER TO PLANT SCHEDULE
 - CONCRETE PAVING WITH MEDIUM BROOM FINISH WITH SAWCUT JOINTS APPROX. AREA: 815m² (8,772 ft²)
 - PROPOSED ASPHALT PAVING PER CIVIL
 - PROPOSED CONCRETE PAVING STONES - TECHNO BLOCK LINE IN PER DETAIL 1, L2.2 QTY: 235m² (2,530 ft²)
 - PROPOSED COURSE CEDAR BARK MULCH NATURAL COLOUR OR 20mm ANGULAR CHARCOAL ROCK MULCH 75mm (3" DEPTH) WITH TYFAR GEOTEXTILE FABRIC APPROX. AREA: 180m² (1,940 ft²)
 - FEATURE BOULDERS (5) - LOCAL STONE APPROX. 500mm HT x 1000mm L x 500mm W BURIED APPROX. 150mm DEPTH

- GENERAL NOTES:**
1. CONTRACTOR TO LOCATE AND PROTECT ALL EXISTING UTILITIES AND SERVICES, BC ONE CALL 1-800-474-6886.
 2. ALL WORK AND MATERIALS ARE TO BE IN ACCORDANCE WITH THE CURRENT EDITIONS OF THE VILLAGE OF SLOCAN CONSTRUCTION STANDARDS, AND THE MASTER MUNICIPAL CONSTRUCTION DOCUMENTS (MCCD) REQUIREMENTS.
 3. CONTRACTOR SHALL VERIFY SITE CONDITIONS PRIOR TO DEMOLITION OR CONSTRUCTION.
 4. CONTRACTOR TO VERIFY ALL DIMENSIONS AND REPORT ANY DISCREPANCIES TO ENGINEER OR LANDSCAPE ARCHITECT. PROPERTY LINES TO BE VERIFIED PRIOR TO CONSTRUCTION.
 5. CONTRACTOR IS RESPONSIBLE TO COORDINATE THE STAGING OF CONSTRUCTION ACTIVITIES AND WORK WITH ALL OTHER CONTRACTORS ON-SITE, INCLUDING IRRIGATION SLEEVING AND WEeping TILE DOWNSPOUT LOCATIONS PRIOR TO HARDSCAPE INSTALLATION.
 6. THE LANDSCAPE ARCHITECT WILL BE NOTIFIED MIN. 48 HOURS PRIOR TO COMMENCEMENT OF WORK.
 7. THE QUANTITIES LISTED ARE ESTIMATES. CONTRACTOR TO VERIFY ALL QUANTITIES THROUGH SITE SURVEY AND REPORT ANY DISCREPANCIES TO ENGINEER OR LANDSCAPE ARCHITECT.
 8. ANY CHANGES OR ALTERATIONS TO DRAWINGS SHALL BE APPROVED BY LANDSCAPE ARCHITECT.
 9. CONTRACTOR TO CONFIRM ELEVATION, LOCATION, AND GRADIENT OF SURROUNDING GRADES AND PROVIDE A SMOOTH TRANSITION.
 10. CONTRACTOR TO BE REGISTERED WITH WORKSAFE BC.

- PLANTING NOTES:**
1. REFER TO PLANT SCHEDULE FOR DETAILED SPECIES INFORMATION L1.2. NO PLANT SUBSTITUTIONS ARE PERMITTED WITHOUT WRITTEN APPROVAL BY LANDSCAPE ARCHITECT.
 2. CONFINE EQUIPMENT AND WORKERS TO LIMIT OF DISTURBANCE WITHIN PHASE I BOUNDARY.
 3. TURF TO BE PLANTED ADJACENT TO DISTURBED AREAS AND OTHER AREAS OF NEW CONSTRUCTION.
 4. PLANT MATERIAL SHALL MEET ALL REQUIREMENTS OF THE LATEST EDITION OF THE CANADIAN NURSERY TRADES ASSOCIATION GUIDE SPECIFICATIONS FOR NURSERY STOCK UNLESS OTHERWISE SPECIFIED.
 5. SUPPLY 75mm OF NATURAL COLOUR CEDAR BARK MULCH OR ANGULAR ROCK MULCH TO ALL PROPOSED TREE AND SHRUB BEDS.
 8. INSTALL 600-1000mm MIN. DEPTH TOPSOIL IN PLANTING AREAS.
 9. TREES AND SHRUBS TO BE GUARANTEED FOR 2 GROWING SEASONS BY CONTRACTOR. ALL REPLACEMENTS TO BE AT CONTRACTOR'S EXPENSE. SUBSTITUTIONS TO BE APPROVED BY LANDSCAPE ARCHITECT.

- TOPSOIL NOTES:**
1. GROWING MEDIUM FOR ALL TREE, SHRUB, AND WILDFLOWER BEDS IS TO MEET THE CANADIAN LANDSCAPE SPECIFICATION UNDER THE DESIGNATION 2P.
 2. GROWING MEDIUM SHOULD BE CERTIFIED TO ITS ORIGIN AND VIRTUALLY FREE OF INVASIVE PLANT SEEDS, THEIR REPRODUCTIVE PARTS AND ROOTS, BUILDING MATERIALS, INVASIVE OR NOXIOUS PLANTS, NON-COMPOSTED WOOD, WOOD WASTE, INSECT PESTS, PLANT PATHOGENIC ORGANISMS, CHEMICAL POLLUTANTS OR SUBSTANCES AT LEVELS TOXIC TO PLANTS, AND OTHER EXTRANEUS MATERIALS THAT DETRACT FROM DESIRABLE PHYSICAL AND CHEMICAL PROPERTIES REQUIRED FOR LANDSCAPING PURPOSES.

- IRRIGATION NOTES:**
1. GENERAL
- TREES, SHRUBS, GRASSES, AND PERENNIALS WILL REQUIRE PERMANENT SPRINKLER AND/OR DRIP LINE IRRIGATION. REFER TO IRRIGATION DRAWINGS AND SPECIFICATIONS.
- LOAM: NATURAL, FERTILE, FRIABLE, AGRICULTURAL SOIL MEETING FOLLOWING REQUIREMENTS:**
- NOT LESS THAN 6% ORGANIC MATERIAL.
 - PH VALUE RANGING FROM 5.9 TO 7.0.
 - NON-TOXIC TO PLANT GROWTH.
 - E.C. SALINITY READING NOT EXCEEDING 1.5.
 - SOIL TEXTURE: LOAM SOIL AS DEFINED BY CANADIAN SYSTEM OF SOIL CLASSIFICATION.
- PEAT MOSS: DECOMPOSED PLANT MATERIAL, FAIRLY ELASTIC AND HOMOGENEOUS, FREE OF DECOMPOSED COLLOIDAL RESIDUE, WOOD, SULPHUR, AND IRON. MINIMUM OF 80% ORGANIC MATTER BY MASS; PH VALUE BETWEEN 4.5 AND 6.0.**

PROJECT:
HAROLD STREET NORTH RECONSTRUCTION

LOCATION:
SLOCAN, BC

LEGAL DESCRIPTION:
LOT A, PLAN NEP20184



CLIENT: VILLAGE OF SLOCAN
T: 250.355.2277
E: admin@villageofslocan.ca

LANDSCAPE ARCHITECT: BCSLA 563



GOLDEN, BC 250.938.7337

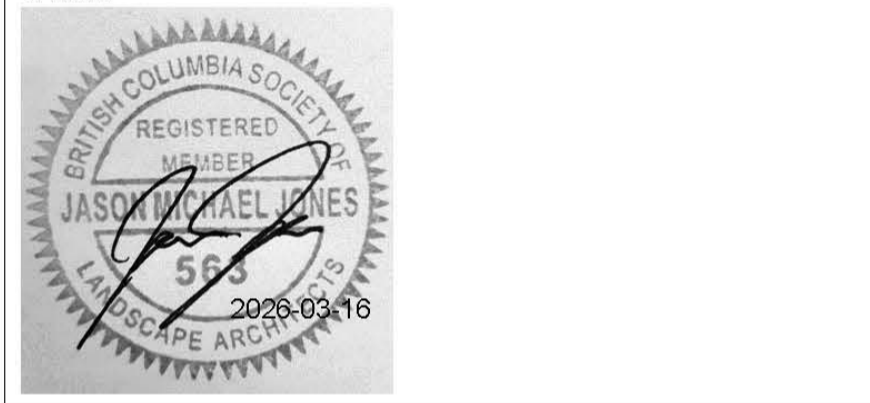

825C LAKESHORE DRIVE W
PO BOX 106 SALMON ARM, BC V1E 4N2
T: 250.832-3220

NOTE: ORIGINAL SIZE ANSI D (22x34")

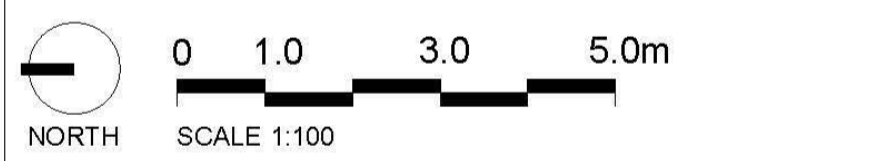

ISSUED FOR: TENDER

DATE: 2026-03-16

NOT FOR CONSTRUCTION

NO.	DESCRIPTION	DATE	BY:
1.	PRELIMINARY DESIGN	2022-10-27	JJ
2.	50% REVIEW	2022-11-09	JJ
3.	75% REVIEW	2022-12-05	JJ
4.	100% REVIEW	2023-01-31	JJ
5.	ISSUED FOR TENDER	2023-02-15	JJ
6.	RE-ISSUED FOR TENDER REVIEW	2025-12-11	JJ
7.	ISSUED FOR TENDER	2026-03-16	JJ

DESIGNED BY: JJ

DRAWING TITLE:
LANDSCAPE PLAN

L-1.2

Any reuse, modification, or alteration of this document and the ideas and designs incorporated herein is at the sole risk of the purchaser. Reusing, modifying, or altering it. All references to Larch Landscape + Authentic Mountain Design and their employees and all professional seals shall be removed prior to any reuse, modification or alteration to this document.

PLANT SCHEDULE

SYMBOL	CODE	BOTANICAL / COMMON NAME	CONT	CAL	QTY
TREES					
	ACE BRD	Acer rubrum 'Bowhall' / Bowhall Red Maple	-	60mm	12
	ACE A12	Acer x freemanii 'Jeffersred' / Autumn Blaze Maple	-	75mm	4
SHRUBS					
	CAL KAR	Calamagrostis x acutiflora 'Karl Foerster' / Feather Reed Grass	#2 CONT.		13
	COR MID	Cornus sanguinea 'Midwinter Fire' / Midwinter Fire Bloodtwig Dogwood	#2 CONT.		2
	DES BRO	Deschampsia cespitosa 'Bronzeschleier' / Tufted Hair Grass	#2 CONT.		35
	EUO COM	Euonymus alatus 'Compactus' / Compact Burning Bush	#5 CONT.		1
	HEL SEM	Helictotrichon sempervirens / Blue Oat Grass	#2 CONT.		12
	LAV MUN	Lavandula angustifolia 'Munstead' / Munstead English Lavender	#1 CONT.		12
	MON CAM	Monarda x 'Cambridge Scarlet' / Red Bee Balm	#1 CONT.		24
	PAN PR2	Panicum virgatum 'Prairie Fire' / Prairie Fire Switch Grass	#2 CONT.		4
	PER ATR	Perovskia atriplicifolia / Russian Sage	#2 CONT.		10
	PHY LIT	Physocarpus opulifolius 'Tiny Wine' / Dwarf Ninebark	#2 CONT.		2
	PIN CO2	Pinus mugo 'Compacta' / Dwarf Mugo Pine	#5 CONT.		4
	RUD GO2	Rudbeckia fulgida sullivantii 'Goldsturm' / Black-eyed Susan	#5 CONT.		21
	SAL CAR	Salvia nemorosa 'Caradonna' / Cardonna Perennial Salvia	#1 CONT.		24
	SED AU3	Sedum x 'Autumn Joy' / Autumn Joy Sedum	#2 CONT.		3

IRRIGATION NOTES:

1. GENERAL
 - TREES, SHRUBS, GRASSES, AND PERENNIALS WILL REQUIRE PERMANENT SPRINKLER AND/OR DRIP LINE IRRIGATION. REFER TO IRRIGATION DRAWINGS AND SPECIFICATIONS.

LEGEND

- EXISTING/PROPOSED UNDERGROUND UTILITIES PER CIVIL
- EXISTING OVERHEAD UTILITIES PER SURVEY
- PROPOSED VEGETATION REFER TO PLANT SCHEDULE
- CONCRETE PAVING WITH MEDIUM BROOM FINISH WITH SAWCUT JOINTS APPROX. AREA: 815m² (8,772 ft²)
- PROPOSED ASPHALT PAVING PER CIVIL
- PROPOSED CONCRETE PAVING STONES - TECHN BLOCK LINE IN PER DETAIL 1, L2 Z QTY: 235m² (2,530 ft²)
- PROPOSED COURSE CEDAR BARK MULCH NATURAL COLOUR OR 20mm ANGULAR CHARCOL ROCK MULCH 75mm (3" DEPTH) WITH TYPAR GEOTEXTILE FABRIC APPROX. AREA: 180m² (1,940 ft²)
- FEATURE BOULDERS (5) - LOCAL STONE APPROX. 500mm HT x 1000mm L x 500mm W BURIED APPROX. 150mm DEPTH

GENERAL NOTES:

1. CONTRACTOR TO LOCATE AND PROTECT ALL EXISTING UTILITIES AND SERVICES, BC ONE CALL 1-800-474-6886.
2. ALL WORK AND MATERIALS ARE TO BE IN ACCORDANCE WITH THE CURRENT EDITIONS OF THE VILLAGE OF SLOCAN CONSTRUCTION STANDARDS, AND THE MASTER MUNICIPAL CONSTRUCTION DOCUMENTS (MMCD) REQUIREMENTS.
3. CONTRACTOR SHALL VERIFY SITE CONDITIONS PRIOR TO DEMOLITION OR CONSTRUCTION.
4. CONTRACTOR TO VERIFY ALL DIMENSIONS AND REPORT ANY DISCREPANCIES TO ENGINEER OR LANDSCAPE ARCHITECT. PROPERTY LINES TO BE VERIFIED PRIOR TO CONSTRUCTION.
5. CONTRACTOR IS RESPONSIBLE TO COORDINATE THE STAGING OF CONSTRUCTION ACTIVITIES AND WORK WITH ALL OTHER CONTRACTORS ON SITE, INCLUDING IRRIGATION SLEEVING AND WEEPING TILE DOWNSPOUT LOCATIONS PRIOR TO HARDSCAPE INSTALLATION.
6. THE LANDSCAPE ARCHITECT WILL BE NOTIFIED MIN. 48 HOURS PRIOR TO COMMENCEMENT OF WORK.
7. THE QUANTITIES LISTED ARE ESTIMATES. CONTRACTOR TO VERIFY ALL QUANTITIES THROUGH SITE SURVEY AND REPORT ANY DISCREPANCIES TO ENGINEER OR LANDSCAPE ARCHITECT.
8. ANY CHANGES OR ALTERATIONS TO DRAWINGS SHALL BE APPROVED BY LANDSCAPE ARCHITECT.
9. CONTRACTOR TO CONFIRM ELEVATION, LOCATION, AND GRADIENT OF SURROUNDING GRADES AND PROVIDE A SMOOTH TRANSITION.
10. CONTRACTOR TO BE REGISTERED WITH WORKSAFE BC.

PLANTING NOTES:

1. REFER TO PLANT SCHEDULE FOR DETAILED SPECIES INFORMATION L1.2. NO PLANT SUBSTITUTIONS ARE PERMITTED WITHOUT WRITTEN APPROVAL BY LANDSCAPE ARCHITECT.
2. CONFINE EQUIPMENT AND WORKERS TO LIMIT OF DISTURBANCE WITHIN PHASE I BOUNDARY.
3. TURF TO BE PLANTED ADJACENT TO DISTURBED AREAS AND OTHER AREAS OF NEW CONSTRUCTION.
4. PLANT MATERIAL SHALL MEET ALL REQUIREMENTS OF THE LATEST EDITION OF THE CANADIAN NURSERY TRADES ASSOCIATION GUIDE SPECIFICATIONS FOR NURSERY STOCK UNLESS OTHERWISE SPECIFIED.
5. SUPPLY 75mm OF NATURAL COLOUR CEDAR BARK MULCH OR ANGULAR ROCK MULCH TO ALL PROPOSED TREE AND SHRUB BEDS.
8. INSTALL 600-1000mm MIN. DEPTH TOPSOIL IN PLANTING AREAS.
9. TREES AND SHRUBS TO BE GUARANTEED FOR 2 GROWING SEASONS BY CONTRACTOR. ALL REPLACEMENTS TO BE AT CONTRACTOR'S EXPENSE. SUBSTITUTIONS TO BE APPROVED BY LANDSCAPE ARCHITECT.

TOPSOIL NOTES:

1. GROWING MEDIUM FOR ALL TREE, SHRUB, AND WILDFLOWER BEDS IS TO MEET THE CANADIAN LANDSCAPE SPECIFICATION UNDER THE DESIGNATION 2P.
 2. GROWING MEDIUM SHOULD BE CERTIFIED TO ITS ORIGIN AND VIRTUALLY FREE OF INVASIVE PLANT SEEDS, THEIR REPRODUCTIVE PARTS AND ROOTS, BUILDING MATERIALS, INVASIVE OR NOXIOUS PLANTS, NON-COMPOSTED WOOD, WOOD WASTE, INSECT PESTS, PLANT PATHOGENIC ORGANISMS, CHEMICAL POLLUTANTS OR SUBSTANCES AT LEVELS TOXIC TO PLANTS, AND OTHER EXTRANEUS MATERIALS THAT DETRACT FROM DESIRABLE PHYSICAL AND CHEMICAL PROPERTIES REQUIRED FOR LANDSCAPING PURPOSES.
- LOAM: NATURAL, FERTILE, FRIABLE, AGRICULTURAL SOIL MEETING FOLLOWING REQUIREMENTS:
- NOT LESS THAN 6% ORGANIC MATERIAL.
 - PH VALUE RANGING FROM 5.9 TO 7.0.
 - NON-TOXIC TO PLANT GROWTH.
 - E.C. SALINITY READING NOT EXCEEDING 1.5.
 - SOIL TEXTURE: LOAM SOIL AS DEFINED BY CANADIAN SYSTEM OF SOIL CLASSIFICATION.
- PEAT MOSS: DECOMPOSED PLANT MATERIAL, FAIRLY ELASTIC AND HOMOGENEOUS, FREE OF DECOMPOSED COLLOIDAL RESIDUE, WOOD, SULPHUR, AND IRON. MINIMUM OF 80% ORGANIC MATTER BY MASS; PH VALUE BETWEEN 4.5 AND 6.0.

PROJECT:
HAROLD STREET NORTH RECONSTRUCTION

LOCATION:
 SLOCAN, BC

LEGAL DESCRIPTION:
 LOT A, PLAN NEP20184

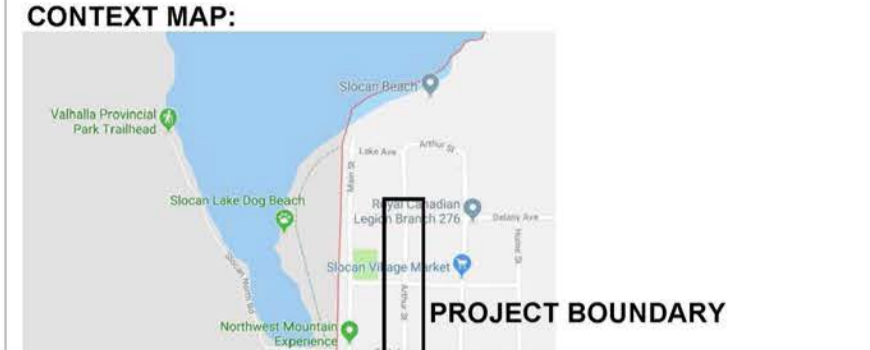

CLIENT:
 VILLAGE OF SLOCAN
T: 250.355.2277
E: admin@villageofslocan.ca

LANDSCAPE ARCHITECT BCSLA 563

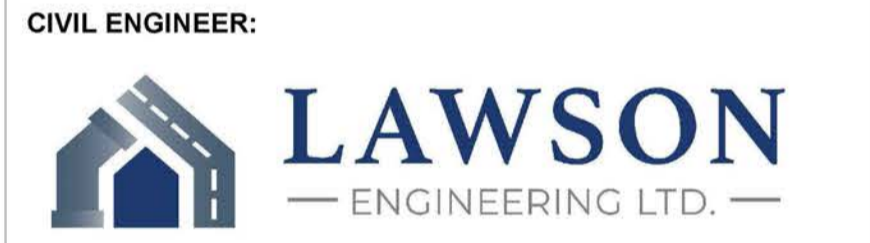

825C LAKESHORE DRIVE W
PO BOX 106 SALMON ARM, BC V1E 4N2
T: 250.832-3220

NOTE: ORIGINAL SIZE ANSI D (22x34")

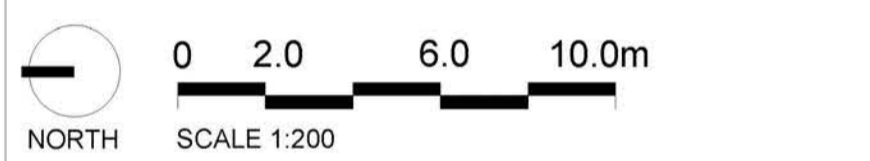

ISSUED FOR: TENDER

DATE: 2026-03-16

NOT FOR CONSTRUCTION

NO.	DESCRIPTION	DATE	BY
1.	PRELIMINARY DESIGN	2022-10-27	JJ
2.	50% REVIEW	2022-11-09	JJ
3.	75% REVIEW	2022-12-05	JJ
4.	100% REVIEW	2023-01-31	JJ
5.	ISSUED FOR TENDER	2023-02-15	JJ
6.	RE-ISSUED FOR TENDER REVIEW	2025-12-11	JJ
7.	ISSUED FOR TENDER	2026-03-16	JJ

DESIGNED BY: JJ

DRAWING TITLE :
PLANT SCHEDULE

L-1.3

Any reuse, modification, or alteration of this document and the ideas and designs incorporated herein is at the sole risk of the purchaser, resuser, modifier, or alterer. All references to Larch Landscape + Authentic Mountain Design and their employees and all professional seals shall be removed prior to any reuse, modification or alteration to this document.

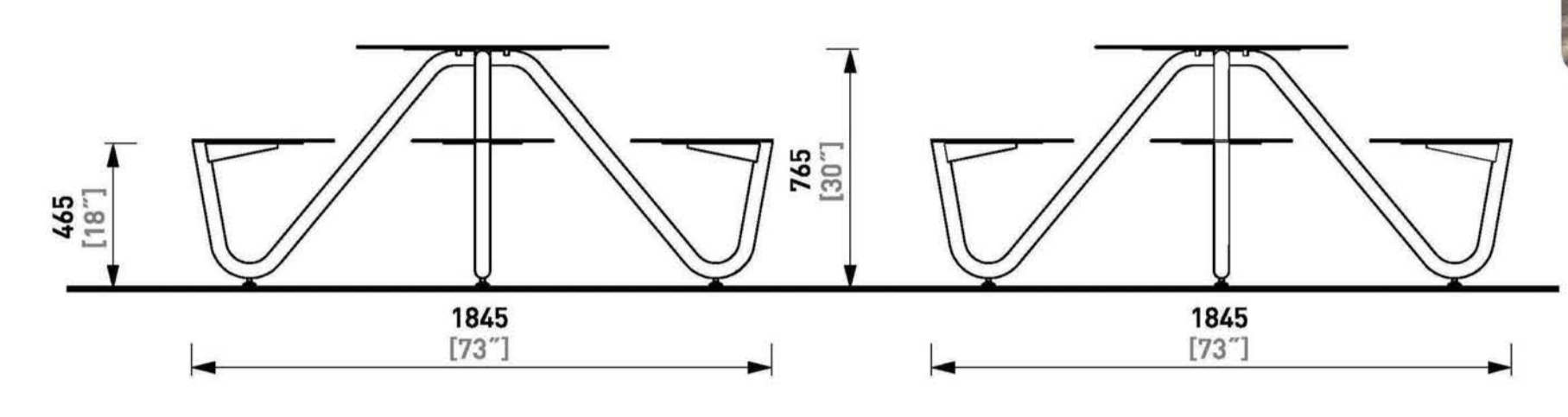

MMCITE | ORBIT | LOB240

- SURFACE MOUNT
- MATERIAL: ALUMINIUM
- COLOUR: AKZO NOBEL

TOTAL QTY: 2

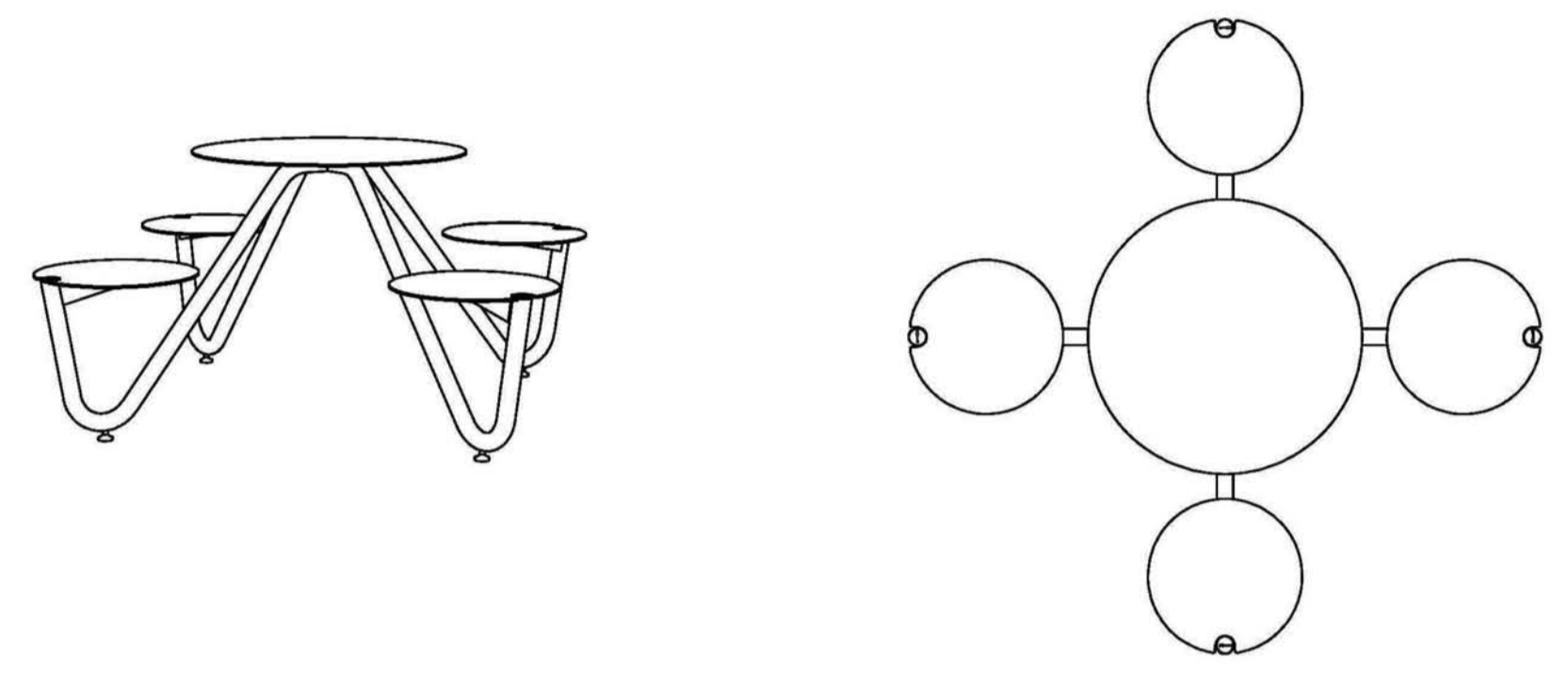

DATE: 05.05.2021 V.02
dimensions in mm [inch]
LOB240 - ORBIT



1 CLUSTER SEATING DETAIL
L2.0 OR APPROVED EQUIVALENT

URBAN FORM WASTE RECEPTACLE
Model Number : UFTR-30

Wishbone site furnishings

PRODUCT SPECIFICATIONS

Perma-Deck T&G Recycled Plastic Slats
This product will not warp, crack, or fade under the UV of the sun.
Colours Available: Black, Grey, Redwood, Sand, Walnut

Durable Powder Coated Aluminum Frame

Standard Colours: Brown Slats, Nickel Metal, Nickel Locks, Stainless Steel, Grey Galv, Stainless Steel, Pressure Sanded, Glossy Red, Black Teakwood, Earth Clay, Modern Bronze, Jacquard Black, Luster Red, Forest Orange, Signal Yellow Traffic, Yellow, Ultra Marine Blue, Water Blue, Yellow Green

Hidden Door Latch
Long Lasting Stainless Steel Hardware
Heavy Duty Aluminum Liner With Drain Holes
Surface Mount

*Foot Pedal Shown is Optional

CUSTOMIZED SOLUTIONS

Custom Powder Coating (Setup Charges May Apply)
MFT-1 Foot pedal mechanism (to open and close folding front loading door)
Bottle and Can Recycler
Urban Cigarette Receptacle
INST-1 Stainless Steel Bolt Down Kit

DESIGNER NOTES

Class-leading design combined with affordability and functionality make the Urban Form Waste Receptacle a must-have to enhance any outdoor setting. Like the rest of the Urban Form Series, the horizontal lumber orientation and minimalist look match well with modern architectural elements. Innovative features such as the keyless hidden door latch system make emptying and cleaning a breeze for any maintenance worker. Minimal fasteners and clever design mean that the recycled plastic boards can be easily replaced if damaged. The 8" opening helps deter locals from emptying their household waste and keeps out water and critters. Available with or without a foot operated pedal.

AVAILABLE RECYCLED PLASTIC LUMBER COLOURS

Black Grey Redwood Sand Walnut

MATERIAL: LIGNIA LUMBER - LIGHT

100% Canadian Made

Wishbone Ltd. provides an extended 10 year limited warranty from the date of invoice.

Visit us online at www.Wishboneltd.com

Wishbone Site Furnishings | #210-27090 Gloucester Way | Langley, BC CANADA V4W 3Y5
1.866.626.0476 sales@wishboneltd.com

POWDER COAT COLOUR: OIL RUBBED BRONZE

WISHBONE SITE FURNISHINGS LTD
210-27090 GLOUCESTER WAY LANGLEY, BC

REVISION: 25/09/17 R.00

DWG. TITLE: URBAN FORM TWO STREAM RECYCLING STATION

MATERIAL: ALUMINIUM	DWG. NO. DWSBGC25091700	DRAWN BY: BRAD SULLIVAN
PATTERN NO. N/A	MODEL NO. UFRS-44	SCALE: 1:16
		SHEET: 1 OF 2
		DATE: 25 SEPT 17

3 BEAR PROOF GARBAGE / RECYCLING BIN DETAIL
L2.0 OR APPROVED EQUIVALENT

2 FEATURE BOULDER DETAIL
L2.0 NTS

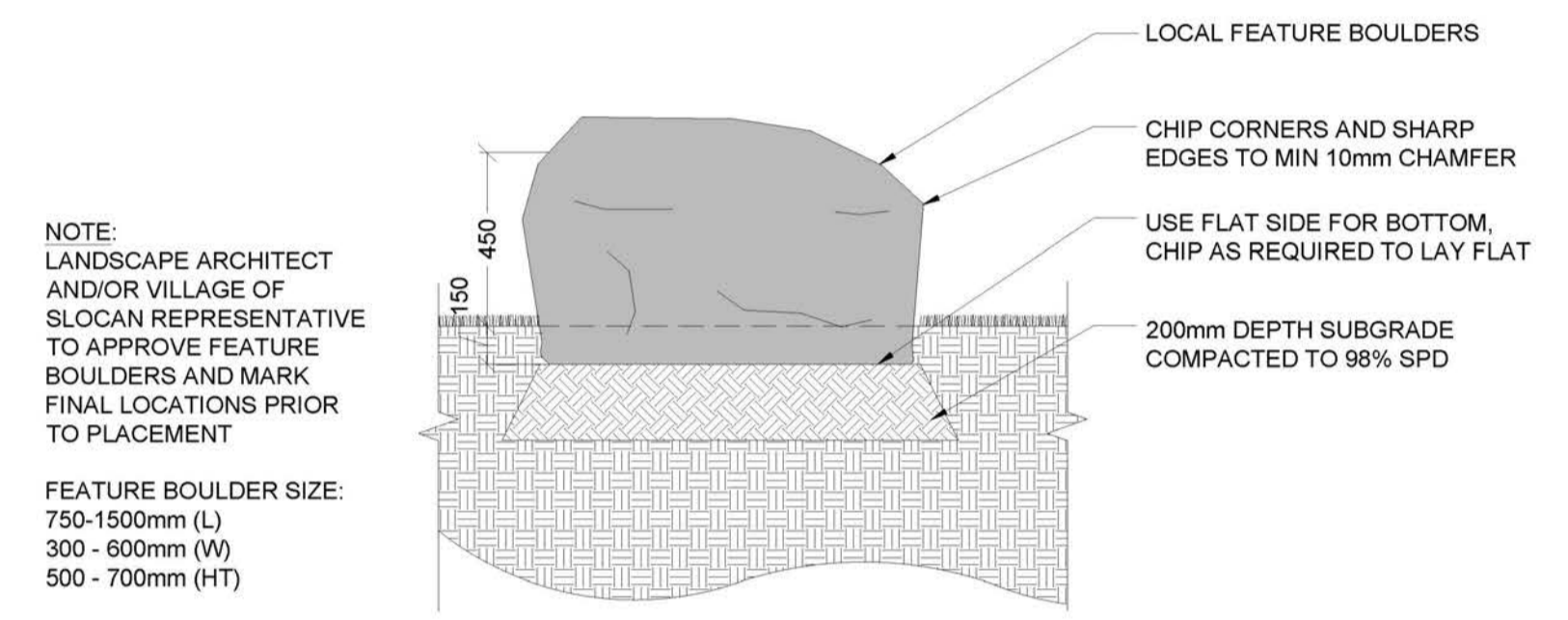

4 EXPANSION JOINT DETAIL
L2.0 1:5

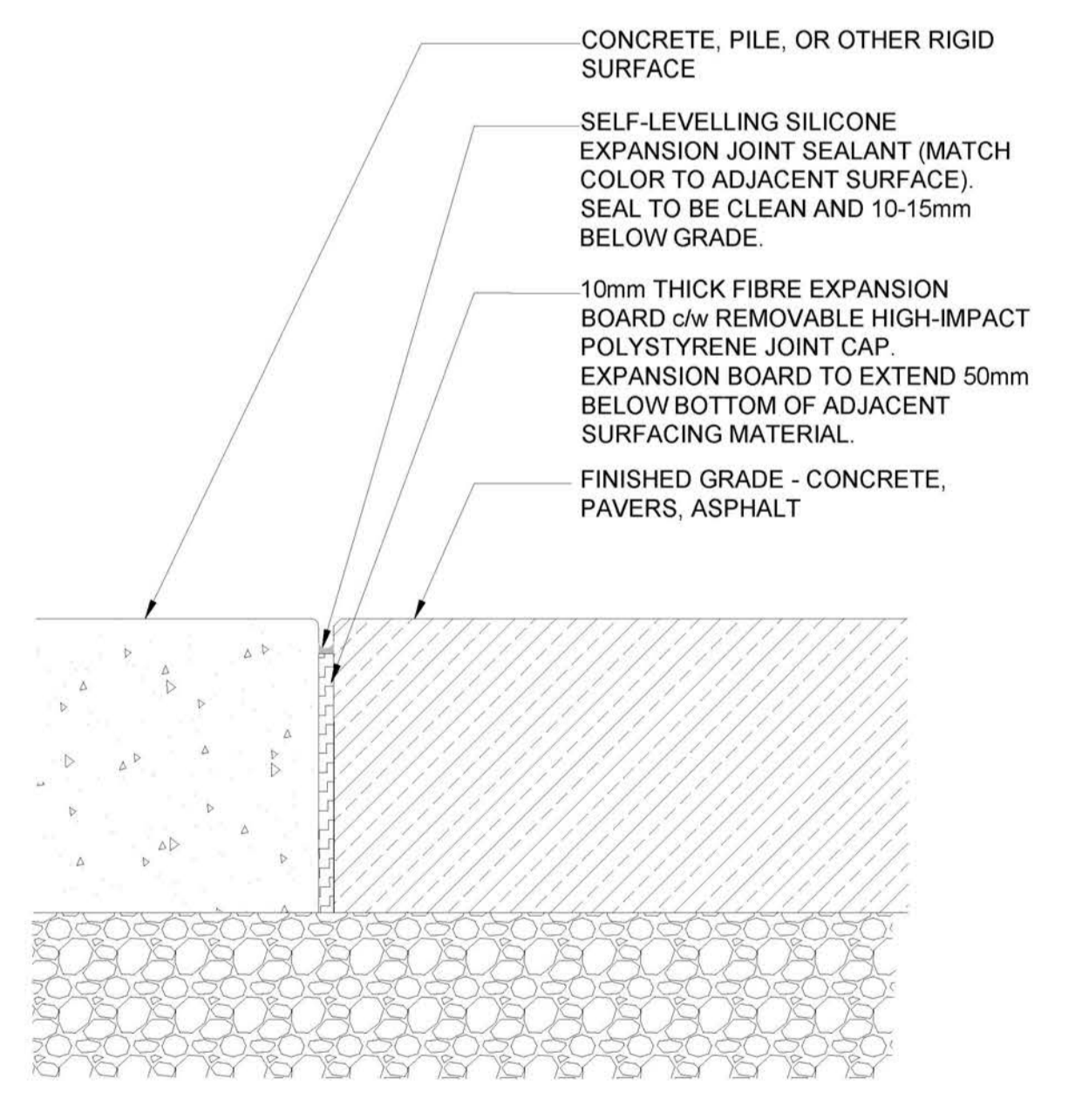

LEGEND

- EXISTING/PROPOSED UNDERGROUND UTILITIES PER CIVIL
- EXISTING OVERHEAD UTILITIES PER SURVEY
- PROPOSED VEGETATION REFER TO PLANT SCHEDULE
- CONCRETE PAVING WITH MEDIUM BROOM FINISH WITH SAWCUT JOINTS
APPROX. AREA: 815m² (8,772 ft²)
- PROPOSED ASPHALT PAVING PER CIVIL
- PROPOSED CONCRETE PAVING STONES - TECHNO BLOCK LINEA IN PER DETAIL 1, L2 Z
QTY: 235m² (2,530 ft²)
- PROPOSED COURSE CEDAR BARK MULCH NATURAL COLOUR OR 20mm ANGULAR CHARCOL ROCK MULCH 75mm (3" DEPTH) WITH TYPAR GEOTEXTILE FABRIC
APPROX. AREA: 180m² (1,940 ft²)
- FEATURE BOULDERS (5) - LOCAL STONE
APPROX. 500mm HT x 1000mm L x 500mm W
BURIED APPROX. 150mm DEPTH

GENERAL NOTES:

- CONTRACTOR TO LOCATE AND PROTECT ALL EXISTING UTILITIES AND SERVICES. BC ONE CALL 1-800-474-6886.
- ALL WORK AND MATERIALS ARE TO BE IN ACCORDANCE WITH THE CURRENT EDITIONS OF THE VILLAGE OF SLOCAN CONSTRUCTION STANDARDS, AND THE MASTER MUNICIPAL CONSTRUCTION DOCUMENTS (MMCDC) REQUIREMENTS.
- CONTRACTOR SHALL VERIFY SITE CONDITIONS PRIOR TO DEMOLITION OR CONSTRUCTION.
- CONTRACTOR TO VERIFY ALL DIMENSIONS AND REPORT ANY DISCREPANCIES TO ENGINEER OR LANDSCAPE ARCHITECT. PROPERTY LINES TO BE VERIFIED PRIOR TO CONSTRUCTION.
- CONTRACTOR IS RESPONSIBLE TO COORDINATE THE STAGING OF CONSTRUCTION ACTIVITIES AND WORK WITH ALL OTHER CONTRACTORS ONSITE, INCLUDING IRRIGATION SLEEVING AND WEEPING TILE DOWNSPOUT LOCATIONS PRIOR TO HARDSCAPE INSTALLATION.
- THE LANDSCAPE ARCHITECT WILL BE NOTIFIED MIN. 48 HOURS PRIOR TO COMMENCEMENT OF WORK.
- THE QUANTITIES LISTED ARE ESTIMATES. CONTRACTOR TO VERIFY ALL QUANTITIES THROUGH SITE SURVEY AND REPORT ANY DISCREPANCIES TO ENGINEER OR LANDSCAPE ARCHITECT.
- ANY CHANGES OR ALTERATIONS TO DRAWINGS SHALL BE APPROVED BY LANDSCAPE ARCHITECT.
- CONTRACTOR TO CONFIRM ELEVATION, LOCATION, AND GRADIENT OF SURROUNDING GRADES AND PROVIDE A SMOOTH TRANSITION.
- CONTRACTOR TO BE REGISTERED WITH WORKSAFE BC.

PLANTING NOTES:

- REFER TO PLANT SCHEDULE FOR DETAILED SPECIES INFORMATION L1.2. NO PLANT SUBSTITUTIONS ARE PERMITTED WITHOUT WRITTEN APPROVAL BY LANDSCAPE ARCHITECT.
- CONFINE EQUIPMENT AND WORKERS TO LIMIT OF DISTURBANCE WITHIN PHASE I BOUNDARY.
- TURF TO BE PLANTED ADJACENT TO DISTURBED AREAS AND OTHER AREAS OF NEW CONSTRUCTION.
- PLANT MATERIAL SHALL MEET ALL REQUIREMENTS OF THE LATEST EDITION OF THE CANADIAN NURSERY TRADES ASSOCIATION GUIDE SPECIFICATIONS FOR NURSERY STOCK UNLESS OTHERWISE SPECIFIED.
- SUPPLY 75mm OF NATURAL COLOUR CEDAR BARK MULCH OR ANGULAR ROCK MULCH TO ALL PROPOSED TREE AND SHRUB BEDS.
- INSTALL 600-1000mm MIN. DEPTH TOPSOIL IN PLANTING AREAS.
- TREES AND SHRUBS TO BE GUARANTEED FOR 2 GROWING SEASONS BY CONTRACTOR. ALL REPLACEMENTS TO BE AT CONTRACTOR'S EXPENSE. SUBSTITUTIONS TO BE APPROVED BY LANDSCAPE ARCHITECT.

TOPSOIL NOTES:

- GROWING MEDIUM FOR ALL TREE, SHRUB, AND WILDFLOWER BEDS IS TO MEET THE CANADIAN LANDSCAPE SPECIFICATION UNDER THE DESIGNATION 2P.
 - GROWING MEDIUM SHOULD BE CERTIFIED TO ITS ORIGIN AND VIRTUALLY FREE OF INVASIVE PLANT SEEDS, THEIR REPRODUCTIVE PARTS AND ROOTS, BUILDING MATERIALS, INVASIVE OR NOXIOUS PLANTS, NON-COMPOSTED WOOD, WOOD WASTE, INSECT PESTS, PLANT PATHOGENIC ORGANISMS, CHEMICAL POLLUTANTS OR SUBSTANCES AT LEVELS TOXIC TO PLANTS, AND OTHER EXTRANEOUS MATERIALS THAT DETRACT FROM DESIRABLE PHYSICAL AND CHEMICAL PROPERTIES REQUIRED FOR LANDSCAPING PURPOSES.
- LOAM: NATURAL, FERTILE, FRIABLE, AGRICULTURAL SOIL MEETING FOLLOWING REQUIREMENTS:
- NOT LESS THAN 6% ORGANIC MATERIAL
 - PH VALUE RANGING FROM 5.9 TO 7.0
 - NON-TOXIC TO PLANT GROWTH
 - E.C. SALINITY READING NOT EXCEEDING 1.5
 - SOIL TEXTURE: LOAM SOIL AS DEFINED BY CANADIAN SYSTEM OF SOIL CLASSIFICATION.
- PEAT MOSS: DECOMPOSED PLANT MATERIAL, FAIRLY ELASTIC AND HOMOGENEOUS, FREE OF DECOMPOSED COLLOIDAL RESIDUE, WOOD, SULPHUR, AND IRON. MINIMUM OF 80% ORGANIC MATTER BY MASS; PH VALUE BETWEEN 4.5 AND 6.0.

PROJECT: HAROLD STREET NORTH RECONSTRUCTION

LOCATION:
SLOCAN, BC

LEGAL DESCRIPTION:
LOT A, PLAN NEP20184



CLIENT:
VILLAGE OF SLOCAN

T: 250.355.2277
E: admin@villageofslocan.ca

LANDSCAPE ARCHITECT: BCSLA 563



CIVIL ENGINEER:

LAWSON ENGINEERING LTD.

825C LAKESHORE DRIVE W
PO BOX 106 SALMON ARM, BC V1E 4N2
T: 250.832-3220

NOTE: ORIGINAL SIZE ANSI D (22x34")

NORTH SCALE 1:200

ISSUED FOR: TENDER

DATE: 2026-03-16

NOT FOR CONSTRUCTION

NO.	DESCRIPTION	DATE	BY
1.	PRELIMINARY DESIGN	2022-10-27	JJ
2.	50% REVIEW	2022-11-09	JJ
3.	75% REVIEW	2022-12-05	JJ
4.	100% REVIEW	2023-01-31	JJ
5.	ISSUED FOR TENDER	2023-02-15	JJ
6.	RE-ISSUED FOR TENDER REVIEW	2025-12-11	JJ
7.	ISSUED FOR TENDER	2026-03-16	JJ

DESIGNED BY: JJ

DRAWING TITLE:
LANDSCAPE DETAILS

L-2.0

Any reuse, modification, or alteration of this document and the ideas and designs incorporated herein is at the sole risk of the party(ies) reusing, modifying, or altering it. All references to Larch Landscape + Authentic Mountain Design and their employees and all professional seals shall be removed prior to any reuse, modification or alteration to this document.

Color Description:

CHAMPLAIN GREY
CHESTNUT BROWN
SHALE GREY

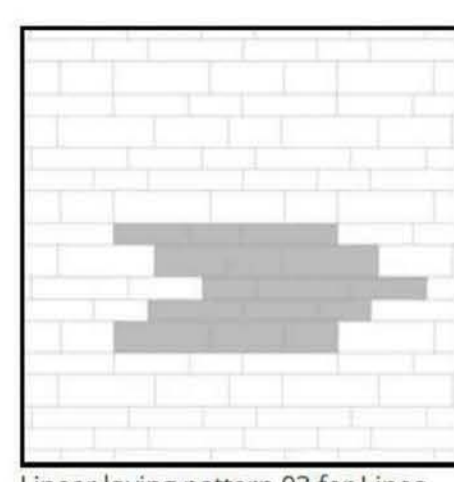

Linear laying pattern 03 for Linea pavers 100 & 150

EXAMPLE OF RANDOMIZED CONCRETE PAVER COLOURS FOR REFERENCE

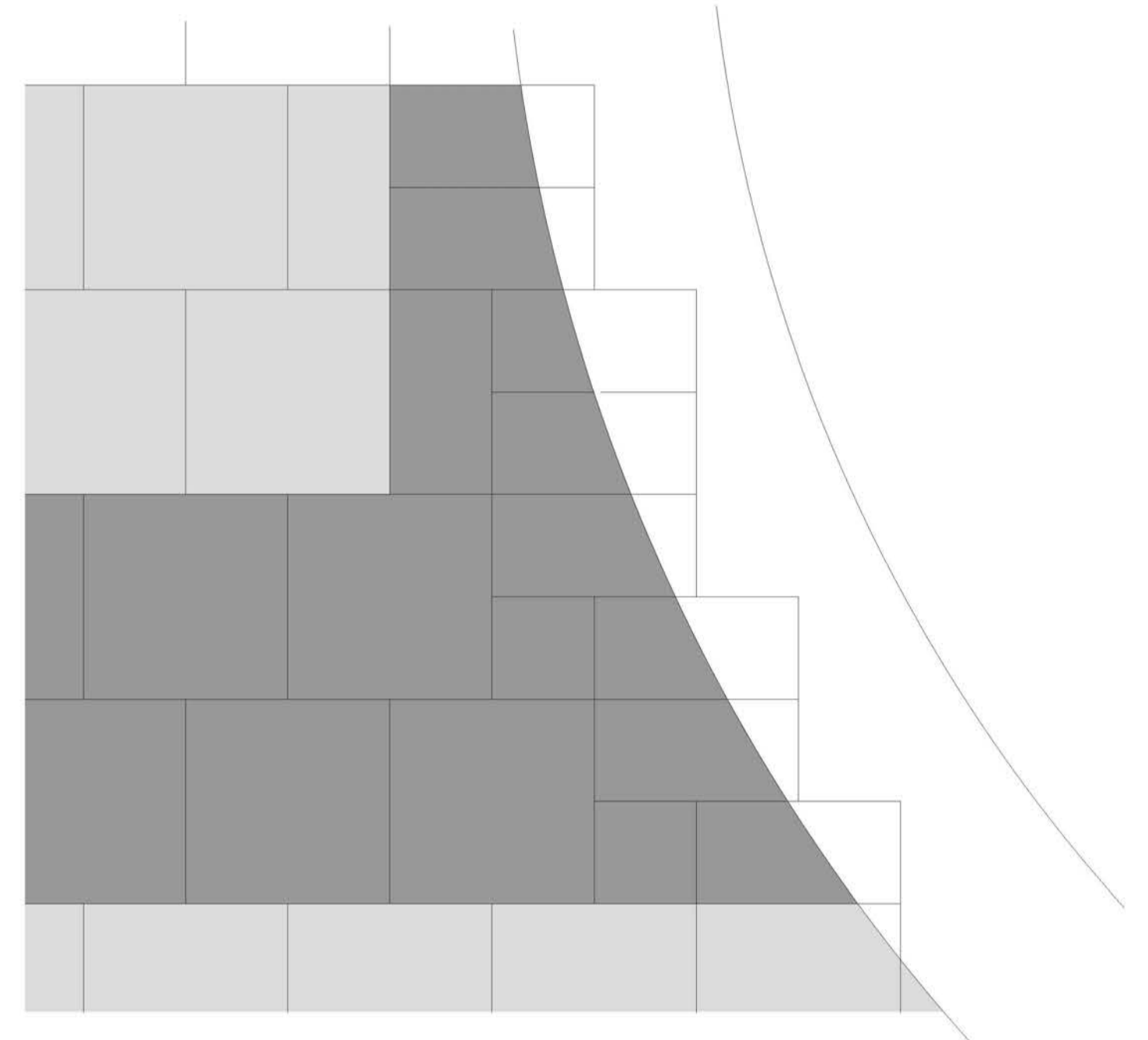

TECHNO BLOCK LINEA CONCRETE PAVERS SIZES: 100 AND 150 IN ALTERNATING ROWS PER PAVING PATTERN 3 COLOURS: CHAMPLAIN, SLATE GREY, CHESNUT BROWN INSTALLED IN RANDOMIZED PATTERN

JOINTS TO BE SWEEPED WITH ROMEX PERMEABLE JOINTING MORTARS PER MANUFACTURER'S SPECIFICATIONS

BEDDING SAND PER MANUFACTURER'S SPECIFICATIONS

GRANULAR BASE COURSE COMPACTED TO 98% S.P.D. PER MANUFACTURER'S SPECS

FABRIC SEPARATOR MANUFACTURER'S SPECS

PREPARED SUBGRADE

2% MIN. SLOPE TO PROVIDE POSITIVE DRAINAGE

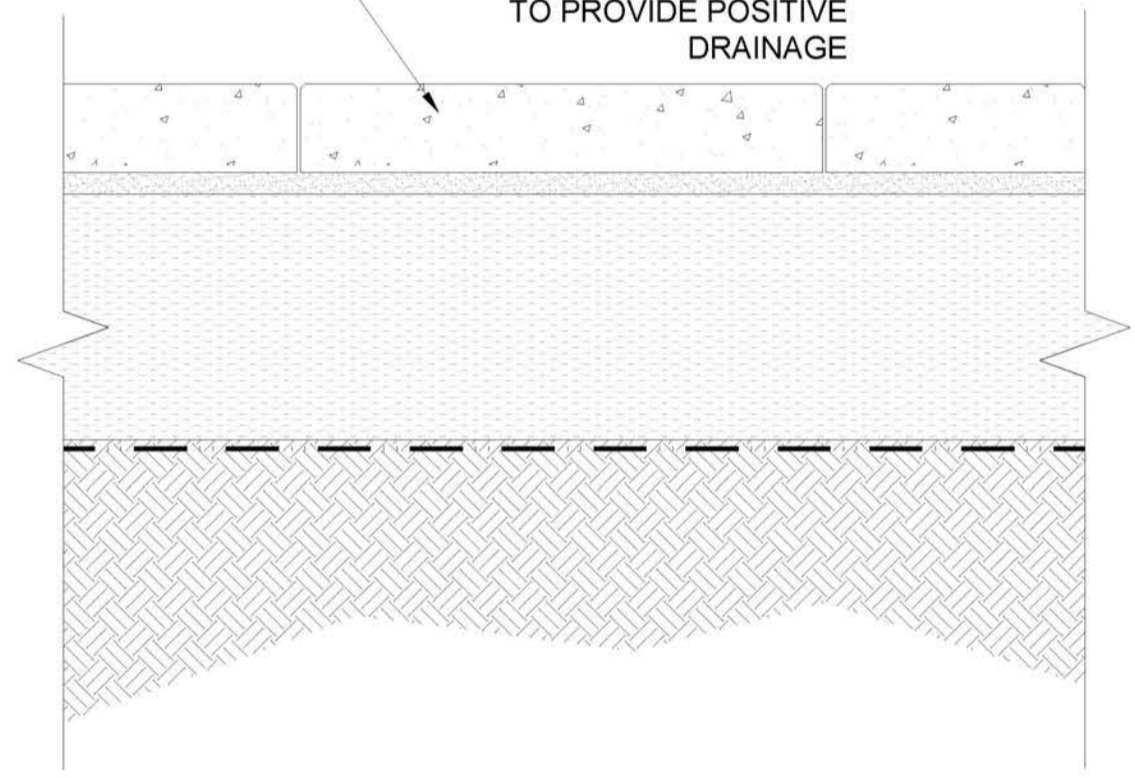

NOTES:

- CONTRACTOR TO SUPPLY 2.0m x 2.0m MOCK UP FOR APPROVAL BY LANDSCAPE ARCHITECT AND/OR VILLAGE OF SLOCAN REPRESENTATIVE PRIOR TO INSTALLATION OF REMAINDER OF PAVING STONES.

1 CONCRETE PAVER DETAIL
L2.2 1:10

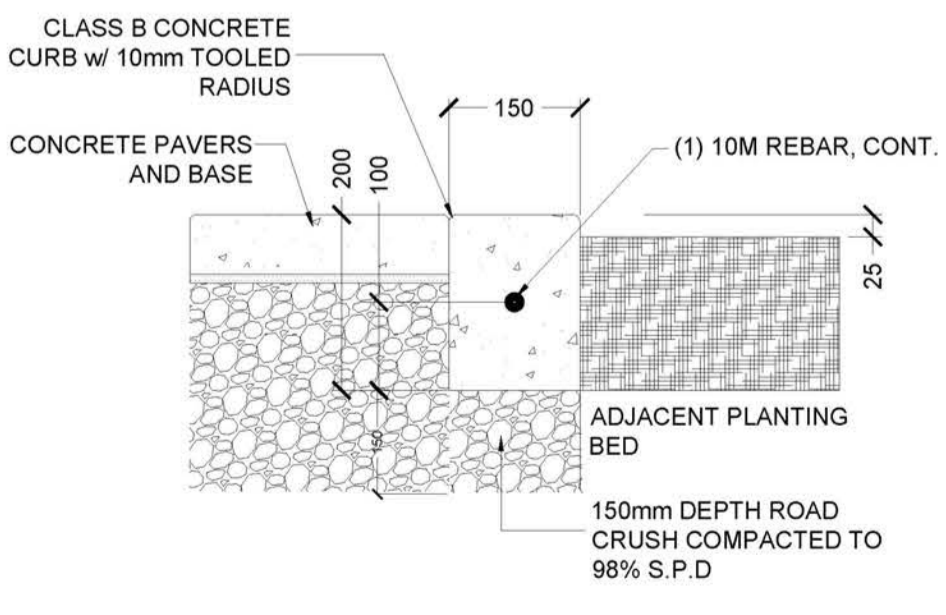

3 AT GRADE CURB DETAIL
L2.2 1:10

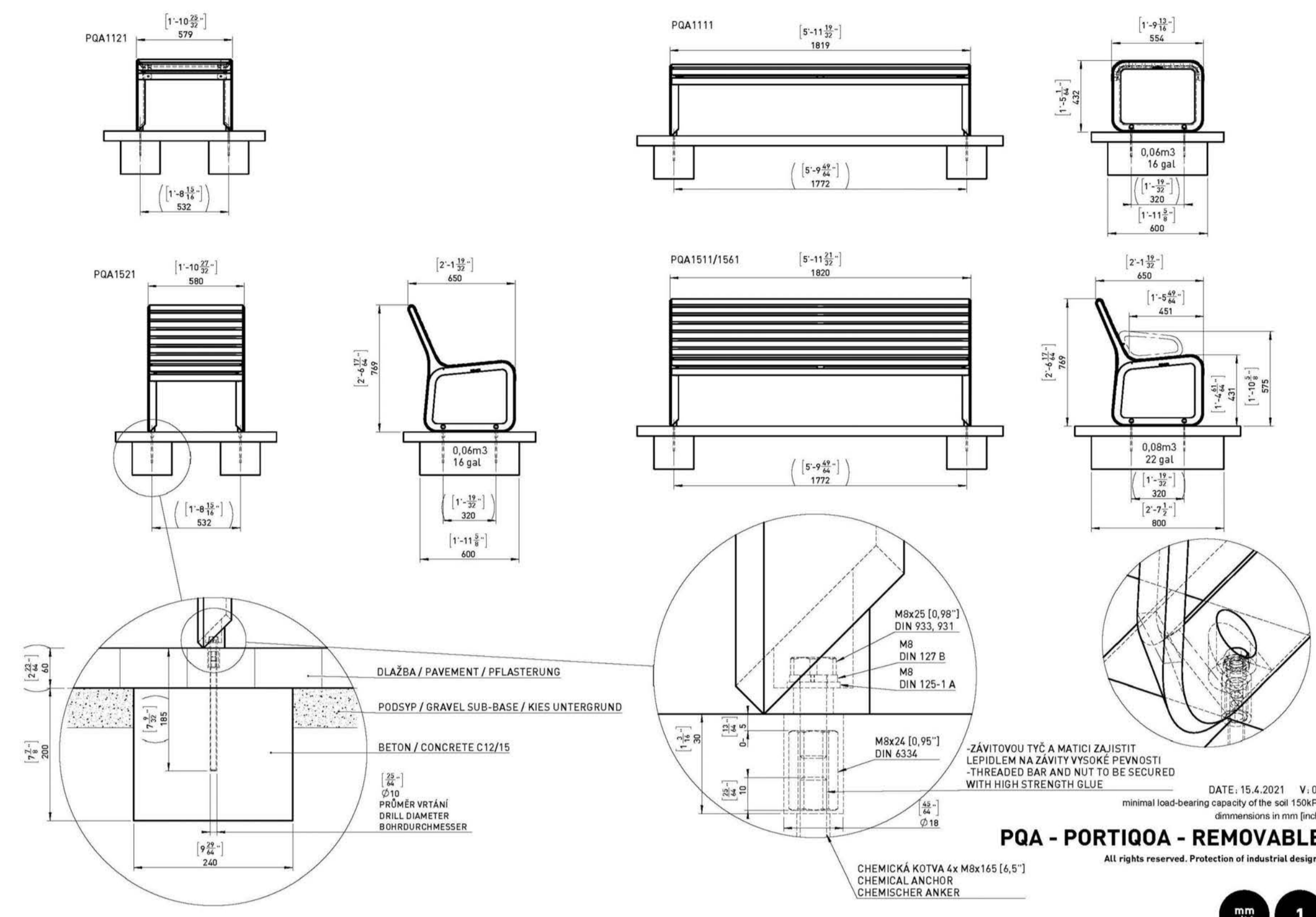

MMCITE | PORTIQOA - BACKED | PQA152

- SURFACE MOUNT
- MATERIAL: IPE HARDWOOD
- COLOUR: AKZO NOBEL

TOTAL QTY:4

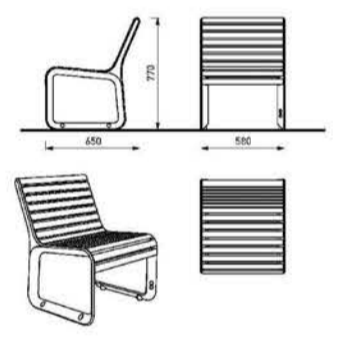

MMCITE | PORTIQOA - BACKED | PQA151

- SURFACE MOUNT
- MATERIAL: IPE HARDWOOD
- COLOUR: AKZO NOBEL

TOTAL QTY:6

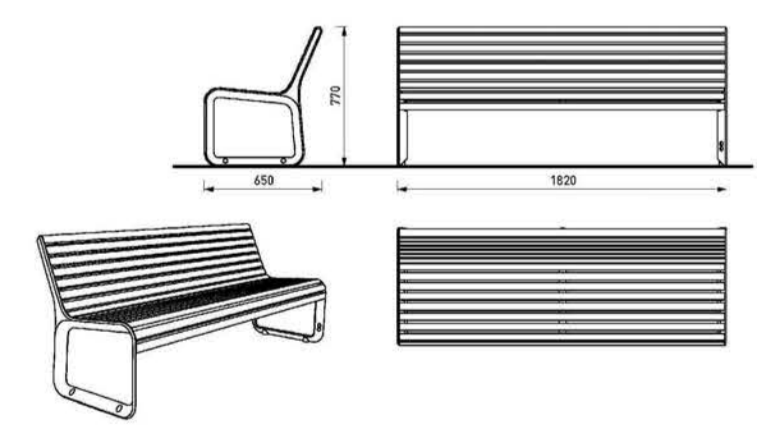

MMCITE | PORTIQOA - BACKLESS | PQA111

- SURFACE MOUNT
- MATERIAL: IPE HARDWOOD
- COLOUR: AKZO NOBEL

TOTAL QTY:6

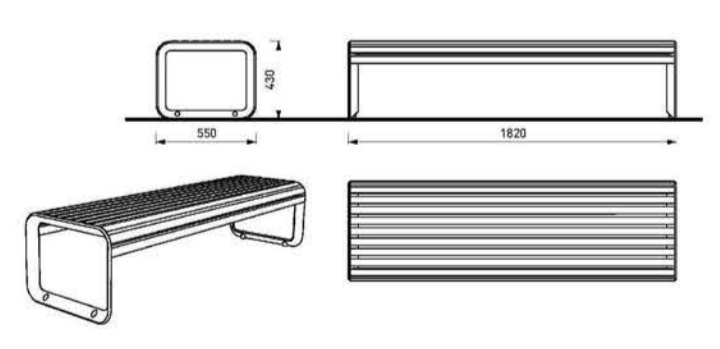

LEGEND

- EXISTING/PROPOSED UNDERGROUND UTILITIES PER CIVIL
- EXISTING OVERHEAD UTILITIES PER SURVEY
- PROPOSED VEGETATION REFER TO PLANT SCHEDULE
- CONCRETE PAVING WITH MEDIUM BROOM FINISH WITH SAWCUT JOINTS APPROX. AREA: 815m² (8,772 ft²)
- PROPOSED ASPHALT PAVING PER CIVIL
- PROPOSED CONCRETE PAVING STONES - TECHNO BLOCK LINEA IN PER DETAIL 1, L2.2 QTY: 235m² (2,530 ft²)
- PROPOSED COURSE CEDAR BARK MULCH NATURAL COLOUR OR 20mm ANGULAR CHARCOAL ROCK MULCH 75mm (3" DEPTH) WITH TYPAR GEOTEXTILE FABRIC APPROX. AREA: 180m² (1,940 ft²)
- FEATURE BOULDERS (5) - LOCAL STONE APPROX. 500mm HT x 1000mm W BURIED APPROX. 150mm DEPTH

GENERAL NOTES:

- CONTRACTOR TO LOCATE AND PROTECT ALL EXISTING UTILITIES AND SERVICES, BC ONE CALL 1-800-474-6886.
- ALL WORK AND MATERIALS ARE TO BE IN ACCORDANCE WITH THE CURRENT EDITIONS OF THE VILLAGE OF SLOCAN CONSTRUCTION STANDARDS, AND THE MASTER MUNICIPAL CONSTRUCTION DOCUMENTS (MCCD) REQUIREMENTS.
- CONTRACTOR SHALL VERIFY SITE CONDITIONS PRIOR TO DEMOLITION OR CONSTRUCTION.
- CONTRACTOR TO VERIFY ALL DIMENSIONS AND REPORT ANY DISCREPANCIES TO ENGINEER OR LANDSCAPE ARCHITECT. PROPERTY LINES TO BE VERIFIED PRIOR TO CONSTRUCTION.
- CONTRACTOR IS RESPONSIBLE TO COORDINATE THE STAGING OF CONSTRUCTION ACTIVITIES AND WORK WITH ALL OTHER CONTRACTORS ON-SITE, INCLUDING IRRIGATION SLEEVING AND WEEPING TILE DOWNPOUT LOCATIONS PRIOR TO HARDSCAPE INSTALLATION.
- THE LANDSCAPE ARCHITECT WILL BE NOTIFIED MIN. 48 HOURS PRIOR TO COMMENCEMENT OF WORK.
- THE QUANTITIES LISTED ARE ESTIMATES. CONTRACTOR TO VERIFY ALL QUANTITIES THROUGH SITE SURVEY AND REPORT ANY DISCREPANCIES TO ENGINEER OR LANDSCAPE ARCHITECT.
- ANY CHANGES OR ALTERATIONS TO DRAWINGS SHALL BE APPROVED BY LANDSCAPE ARCHITECT.
- CONTRACTOR TO CONFIRM ELEVATION, LOCATION, AND GRADIENT OF SURROUNDING GRADES AND PROVIDE A SMOOTH TRANSITION.
- CONTRACTOR TO BE REGISTERED WITH WORKSAFE BC.

PLANTING NOTES:

- REFER TO PLANT SCHEDULE FOR DETAILED SPECIES INFORMATION L1.2. NO PLANT SUBSTITUTIONS ARE PERMITTED WITHOUT WRITTEN APPROVAL BY LANDSCAPE ARCHITECT.
- CONFINE EQUIPMENT AND WORKERS TO LIMIT OF DISTURBANCE WITHIN PHASE I BOUNDARY.
- TURF TO BE PLANTED ADJACENT TO DISTURBED AREAS AND OTHER AREAS OF NEW CONSTRUCTION.
- PLANT MATERIAL SHALL MEET ALL REQUIREMENTS OF THE LATEST EDITION OF THE CANADIAN NURSERY TRADES ASSOCIATION GUIDE SPECIFICATIONS FOR NURSERY STOCK UNLESS OTHERWISE SPECIFIED.
- SUPPLY 75mm OF NATURAL COLOUR CEDAR BARK MULCH OR ANGULAR ROCK MULCH TO ALL PROPOSED TREE AND SHRUB BEDS.
- INSTALL 600-1000mm MIN. DEPTH TOPSOIL IN PLANTING AREAS.
- TREES AND SHRUBS TO BE GUARANTEED FOR 2 GROWING SEASONS BY CONTRACTOR. ALL REPLACEMENTS TO BE AT CONTRACTOR'S EXPENSE. SUBSTITUTIONS TO BE APPROVED BY LANDSCAPE ARCHITECT.

TOPSOIL NOTES:

- GROWING MEDIUM FOR ALL TREE, SHRUB, AND WILDFLOWER BEDS IS TO MEET THE CANADIAN LANDSCAPE SPECIFICATION UNDER THE DESIGNATION 2P.
- GROWING MEDIUM SHOULD BE CERTIFIED TO ITS ORIGIN AND VIRTUALLY FREE OF INVASIVE PLANT SEEDS, THEIR REPRODUCTIVE PARTS AND ROOTS, BUILDING MATERIALS, INVASIVE OR NOXIOUS PLANTS, NON-COMPOSTED WOOD, WOOD WASTE, INSECT PESTS, PLANT PATHOGENIC ORGANISMS, CHEMICAL POLLUTANTS OR SUBSTANCES AT LEVELS TOXIC TO PLANTS, AND OTHER EXTRANEUS MATERIALS THAT DETRACT FROM DESIRABLE PHYSICAL AND CHEMICAL PROPERTIES REQUIRED FOR LANDSCAPING PURPOSES.

LOAM: NATURAL, FERTILE, FRIABLE, AGRICULTURAL SOIL MEETING FOLLOWING REQUIREMENTS:

- NOT LESS THAN 6% ORGANIC MATERIAL
- PH VALUE RANGING FROM 5.9 TO 7.0.
- NON-TOXIC TO PLANT GROWTH.
- E.C. SALINITY READING NOT EXCEEDING 1.5.
- SOIL TEXTURE: LOAM SOIL AS DEFINED BY CANADIAN SYSTEM OF SOIL CLASSIFICATION.

PEAT MOSS: DECOMPOSED PLANT MATERIAL, FAIRLY ELASTIC AND HOMOGENEOUS, FREE OF DECOMPOSED COLLOIDAL RESIDUE, WOOD, SULPHUR, AND IRON. MINIMUM OF 80% ORGANIC MATTER BY MASS; PH VALUE BETWEEN 4.5 AND 6.0.

PROJECT:
HAROLD STREET NORTH RECONSTRUCTION

LOCATION:
SLOCAN, BC

LEGAL DESCRIPTION:
LOT A, PLAN NEP20184

CONTEXT MAP:

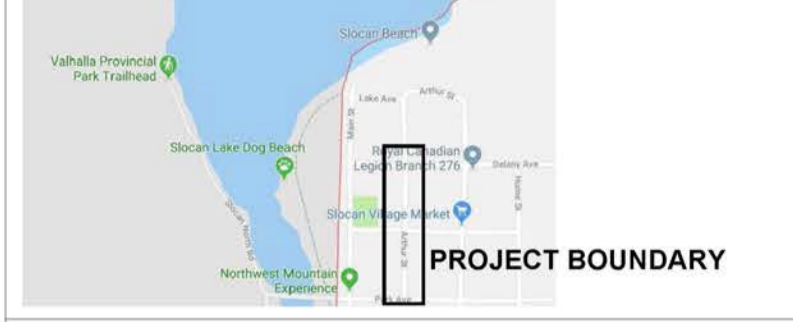

CLIENT:
VILLAGE OF SLOCAN
T: 250.355.2277
E: admin@villageofslocan.ca

LANDSCAPE ARCHITECT BCSLA 563



STAMP

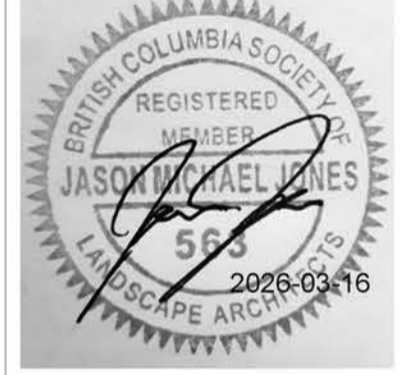

CIVIL ENGINEER:
LAWSON
ENGINEERING LTD.

825C LAKESHORE DRIVE W
PO BOX 106 SALMON ARM, BC V1E 4N2
T: 250.832-3220

NOTE: ORIGINAL SIZE ANSI D (22x34")

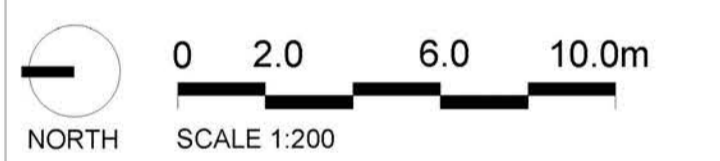

ISSUED FOR: TENDER

DATE: 2026-03-16

NOT FOR CONSTRUCTION

NO.	DESCRIPTION	DATE	BY.
1.	PRELIMINARY DESIGN	2022-10-27	JJ
2.	50% REVIEW	2022-11-09	JJ
3.	75% REVIEW	2022-12-05	JJ
4.	100% REVIEW	2023-01-31	JJ
5.	ISSUED FOR TENDER	2023-02-15	JJ
6.	RE-ISSUED FOR TENDER REVIEW	2025-12-11	JJ
7.	ISSUED FOR TENDER	2026-03-16	JJ

DESIGNED BY: JJ

DRAWING TITLE:
LANDSCAPE DETAILS

L-2.2

Any reuse, modification, or alteration of this document and the ideas and designs incorporated herein is at the sole risk of the purchaser. Reusing, modifying, or altering it. All references to Larch Landscape + Authentic Mountain Design and their employees and all professional seals shall be removed prior to any reuse, modification or alteration to this document.

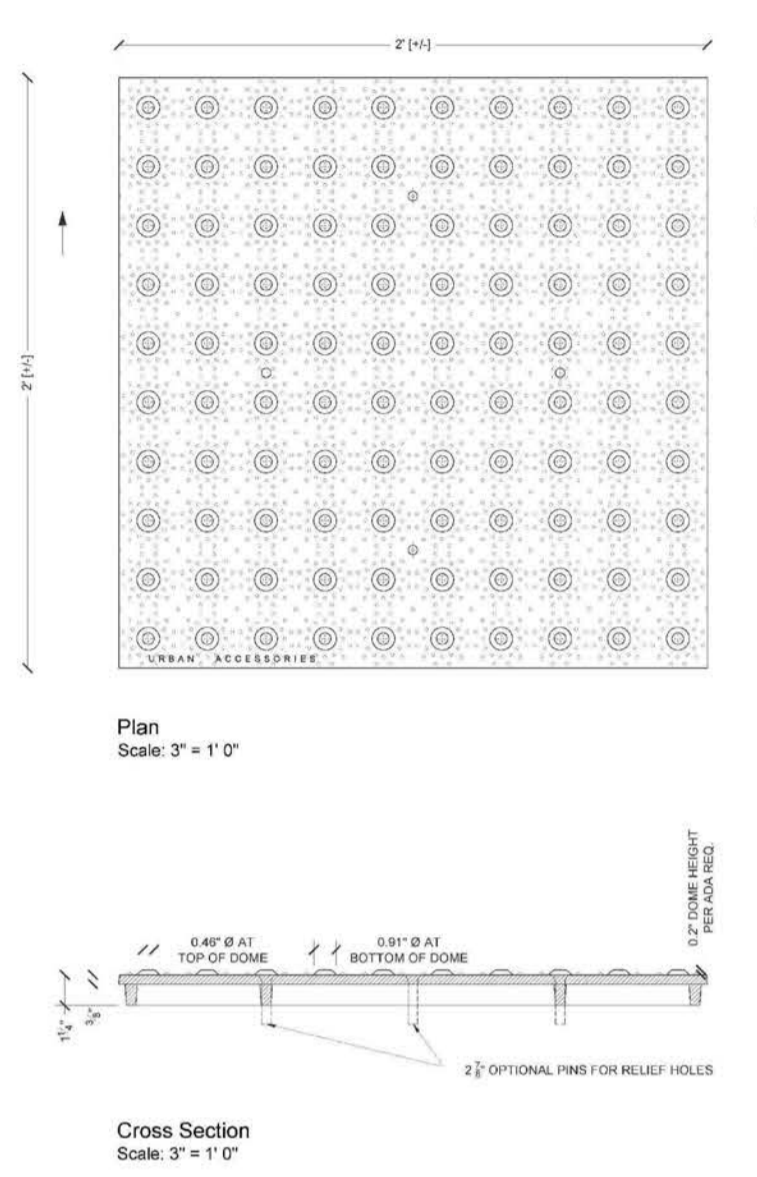

FINISH: RAW STEEL WITH RUST CONDITIONER

NOTE:
1. TACTILE WARNING PLATES ARE A COMBINATION OF STRAIGHT AND RADII. REFER TO PLAN.

1
L2.3 **24" TACTILE WARNING PLATE DETAIL OR APPROVED EQUIVALENT**

SCBR I 600 SERIES

MATERIALS: The Bike Rack is made from solid cast aluminum.

FINISH: The Maglin Powdercoat System provides a durable finish on all metal surfaces.

INSTALLATION: The bike rack is delivered pre-assembled. It is available with either a surface mount or direct burst installation option.

TO SPECIFY: Selected SCBR1600 Series
 Choose:
 - Base Type
 - Direct Burst (SCBR1600-DB)
 - Surface Mount (SCBR1600-S)
 - Powdercoat Color: **BRONZE 14 FINETEX**

COMPLEMENTARY PRODUCTS:
 - SCB1600
 - SCB1600B
 - SCRC1600

DIMENSIONS:
 Length: 27.62" (70.17 cm)
 Height: 25.19" (63.98 cm)
 Width: 3.31" (8.51 cm)
 Weight: 18.3lbs (8.3kg)

SCBR1600-S surface mount model shown.

27.50"

25.31"

3.78"

3
L2.3 **BIKE RACK DETAIL OR APPROVED EQUIVALENT**

URBAN ACCESSORIES

4635 E. FIFTEENTH ST. SUITE 100
TACOMA, WA 98403
(877) 487-0488

Project Name: Blank
 Submitted By: Blank
 Date Submitted: 10/23/2023
 Project Location: Tacoma, WA
 Page # 1 of 1

TRUNCATED DOME PANEL

STANDARD SPECIFICATIONS

OPTIONS

ADDITIONAL NOTES

DRAWING INFO

2
L2.3 **TREE GRATE DETAIL OR APPROVED EQUIVALENT**

URBAN ACCESSORIES

4635 E. FIFTEENTH ST. SUITE 100
TACOMA, WA 98403
(877) 487-0488

Project Name: Blank
 Submitted By: Blank
 Date Submitted: 10/23/2023
 Project Location: Tacoma, WA
 Page # 1 of 1

TRUNCATED DOME PANEL

STANDARD SPECIFICATIONS

OPTIONS

ADDITIONAL NOTES

DRAWING INFO

Plan View

Section A-A'

Section B-B'

FINISH: RAW STEEL WITH RUST CONDITIONER

URBAN ACCESSORIES

4635 E. FIFTEENTH ST. SUITE 100
TACOMA, WA 98403
(877) 487-0488

Project Name: Blank
 Submitted By: Blank
 Date Submitted: 10/23/2023
 Project Location: Tacoma, WA
 Page # 1 of 1

TRUNCATED DOME PANEL

STANDARD SPECIFICATIONS

OPTIONS

ADDITIONAL NOTES

DRAWING INFO

Plan View

Section A-A'

Section B-B'

FINISH: RAW STEEL WITH RUST CONDITIONER

LEGEND

- EXISTING/PROPOSED UNDERGROUND UTILITIES PER CIVIL
- EXISTING OVERHEAD UTILITIES PER SURVEY
- PROPOSED VEGETATION REFER TO PLANT SCHEDULE
- CONCRETE PAVING WITH MEDIUM BROOM FINISH WITH SAWCUT JOINTS APPROX. AREA: 815m² (8,772 ft²)
- PROPOSED ASPHALT PAVING PER CIVIL
- PROPOSED CONCRETE PAVING STONES - TECHNO BLOCK LINEA IN PER DETAIL 1, L2 Z QTY: 235m² (2,530 ft²)
- PROPOSED COURSE CEDAR BARK MULCH NATURAL COLOUR OR 20mm ANGULAR GEOTEX. ROCK MULCH 75mm (3" DEPTH) WITH TYPAR GEOTEXTILE FABRIC APPROX. AREA: 180m² (1,940 ft²)
- FEATURE BOLDERS (5) - LOCAL STONE APPROX. 500mm HT x 1000mm L x 500mm W BURIED APPROX. 150mm DEPTH

- GENERAL NOTES:**
- CONTRACTOR TO LOCATE AND PROTECT ALL EXISTING UTILITIES AND SERVICES. BC ONE CALL 1-800-474-6886.
 - ALL WORK AND MATERIALS ARE TO BE IN ACCORDANCE WITH THE CURRENT EDITIONS OF THE VILLAGE OF SLOCAN CONSTRUCTION STANDARDS, AND THE MASTER MUNICIPAL CONSTRUCTION DOCUMENTS (MCCD) REQUIREMENTS.
 - CONTRACTOR SHALL VERIFY SITE CONDITIONS PRIOR TO DEMOLITION OR CONSTRUCTION.
 - CONTRACTOR TO VERIFY ALL DIMENSIONS AND REPORT ANY DISCREPANCIES TO ENGINEER OR LANDSCAPE ARCHITECT. PROPERTY LINES TO BE VERIFIED PRIOR TO CONSTRUCTION.
 - CONTRACTOR IS RESPONSIBLE TO COORDINATE THE STAGING OF CONSTRUCTION ACTIVITIES AND WORK WITH ALL OTHER CONTRACTORS ONSITE, INCLUDING IRRIGATION SLEEVING AND WEEPING TILE DOWNPOUT LOCATIONS PRIOR TO HARDSCAPE INSTALLATION.
 - THE LANDSCAPE ARCHITECT WILL BE NOTIFIED MIN. 48 HOURS PRIOR TO COMMENCEMENT OF WORK.
 - THE QUANTITIES LISTED ARE ESTIMATES. CONTRACTOR TO VERIFY ALL QUANTITIES THROUGH SITE SURVEY AND REPORT ANY DISCREPANCIES TO ENGINEER OR LANDSCAPE ARCHITECT.
 - ANY CHANGES OR ALTERATIONS TO DRAWINGS SHALL BE APPROVED BY LANDSCAPE ARCHITECT.
 - CONTRACTOR TO CONFIRM ELEVATION, LOCATION, AND GRADIENT OF SURROUNDING GRADES AND PROVIDE A SMOOTH TRANSITION.
 - CONTRACTOR TO BE REGISTERED WITH WORKSAFE BC.

- PLANTING NOTES:**
- REFER TO PLANT SCHEDULE FOR DETAILED SPECIES INFORMATION L1.2. NO PLANT SUBSTITUTIONS ARE PERMITTED WITHOUT WRITTEN APPROVAL BY LANDSCAPE ARCHITECT.
 - CONFINE EQUIPMENT AND WORKERS TO LIMIT OF DISTURBANCE WITHIN PHASE I BOUNDARY.
 - TURF TO BE PLANTED ADJACENT TO DISTURBED AREAS AND OTHER AREAS OF NEW CONSTRUCTION.
 - PLANT MATERIAL SHALL MEET ALL REQUIREMENTS OF THE LATEST EDITION OF THE CANADIAN NURSERY TRADES ASSOCIATION GUIDE SPECIFICATIONS FOR NURSERY STOCK UNLESS OTHERWISE SPECIFIED.
 - SUPPLY 75mm OF NATURAL COLOUR CEDAR BARK MULCH OR ANGULAR ROCK MULCH TO ALL PROPOSED TREE AND SHRUB BEDS.
 - INSTALL 600-1000mm MIN. DEPTH TOPSOIL IN PLANTING AREAS.
 - TREES AND SHRUBS TO BE GUARANTEED FOR 2 GROWING SEASONS BY CONTRACTOR. ALL REPLACEMENTS TO BE AT CONTRACTOR'S EXPENSE. SUBSTITUTIONS TO BE APPROVED BY LANDSCAPE ARCHITECT.
- TOPSOIL NOTES:**
- GROWING MEDIUM FOR ALL TREE, SHRUB, AND WILDFLOWER BEDS IS TO MEET THE CANADIAN LANDSCAPE SPECIFICATION UNDER THE DESIGNATION 2P.
 - GROWING MEDIUM SHOULD BE CERTIFIED TO ITS ORIGIN AND VIRTUALLY FREE OF INVASIVE PLANT SEEDS, THEIR REPRODUCTIVE PARTS AND ROOTS, BUILDING MATERIALS, INVASIVE OR NOXIOUS PLANTS, NON-COMPOSTED WOOD, WOOD WASTE, INSECT PESTS, PLANT PATHOGENIC ORGANISMS, CHEMICAL POLLUTANTS OR SUBSTANCES AT LEVELS TOXIC TO PLANTS, AND OTHER EXTRANEUS MATERIALS THAT DETRACT FROM DESIRABLE PHYSICAL AND CHEMICAL PROPERTIES REQUIRED FOR LANDSCAPING PURPOSES.
- LOAM: NATURAL, FERTILE, FRIABLE, AGRICULTURAL SOIL MEETING FOLLOWING REQUIREMENTS:**
- NOT LESS THAN 6% ORGANIC MATERIAL.
 - PH VALUE RANGING FROM 5.9 TO 7.0.
 - NON-TOXIC TO PLANT GROWTH.
 - E.C. SALINITY READING NOT EXCEEDING 1.5.
 - SOIL TEXTURE: LOAM SOIL AS DEFINED BY CANADIAN SYSTEM OF SOIL CLASSIFICATION.
- PEAT MOSS: DECOMPOSED PLANT MATERIAL, FAIRLY ELASTIC AND HOMOGENEOUS, FREE OF DECOMPOSED COLLOIDAL RESIDUE, WOOD, SULPHUR, AND IRON. MINIMUM OF 80% ORGANIC MATTER BY MASS; PH VALUE BETWEEN 4.5 AND 6.0.**

PROJECT:
HAROLD STREET NORTH RECONSTRUCTION

LOCATION:
SLOCAN, BC

LEGAL DESCRIPTION:
LOT A, PLAN NEP20184



CLIENT: VILLAGE OF SLOCAN
T: 250.355.2277
E: admin@villageofslocan.ca

LANDSCAPE ARCHITECT: BCSLA 563



CIVIL ENGINEER:
LAWSON ENGINEERING LTD.

**825C LAKESHORE DRIVE W
PO BOX 106 SALMON ARM, BC V1E 4N2
T: 250.832-3220**

NOTE: ORIGINAL SIZE ANSI D (22x34")

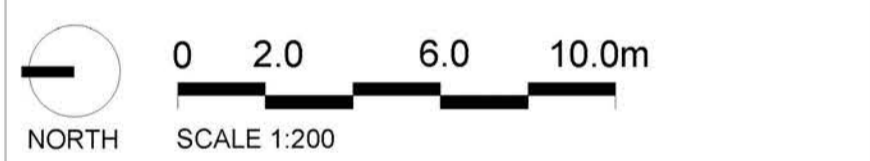

ISSUED FOR: TENDER

DATE: 2026-03-16
NOT FOR CONSTRUCTION

NO.	DESCRIPTION	DATE	BY
1.	PRELIMINARY DESIGN	2022-10-27	JJ
2.	50% REVIEW	2022-11-09	JJ
3.	75% REVIEW	2022-12-05	JJ
4.	100% REVIEW	2023-01-31	JJ
5.	ISSUED FOR TENDER	2023-02-15	JJ
6.	RE-ISSUED FOR TENDER REVIEW	2025-12-11	JJ
7.	ISSUED FOR TENDER	2026-03-16	JJ

DESIGNED BY: JJ

DRAWING TITLE:
LANDSCAPE DETAILS

L-2.3

Any reuse, modification, or alteration of this document and the ideas and designs incorporated herein is at the sole risk of the purchaser, resuser, modifier, or alterer. All references to Larch Landscape + Authentic Mountain Design and their employees and all professional seals shall be removed prior to any reuse, modification or alteration to this document.

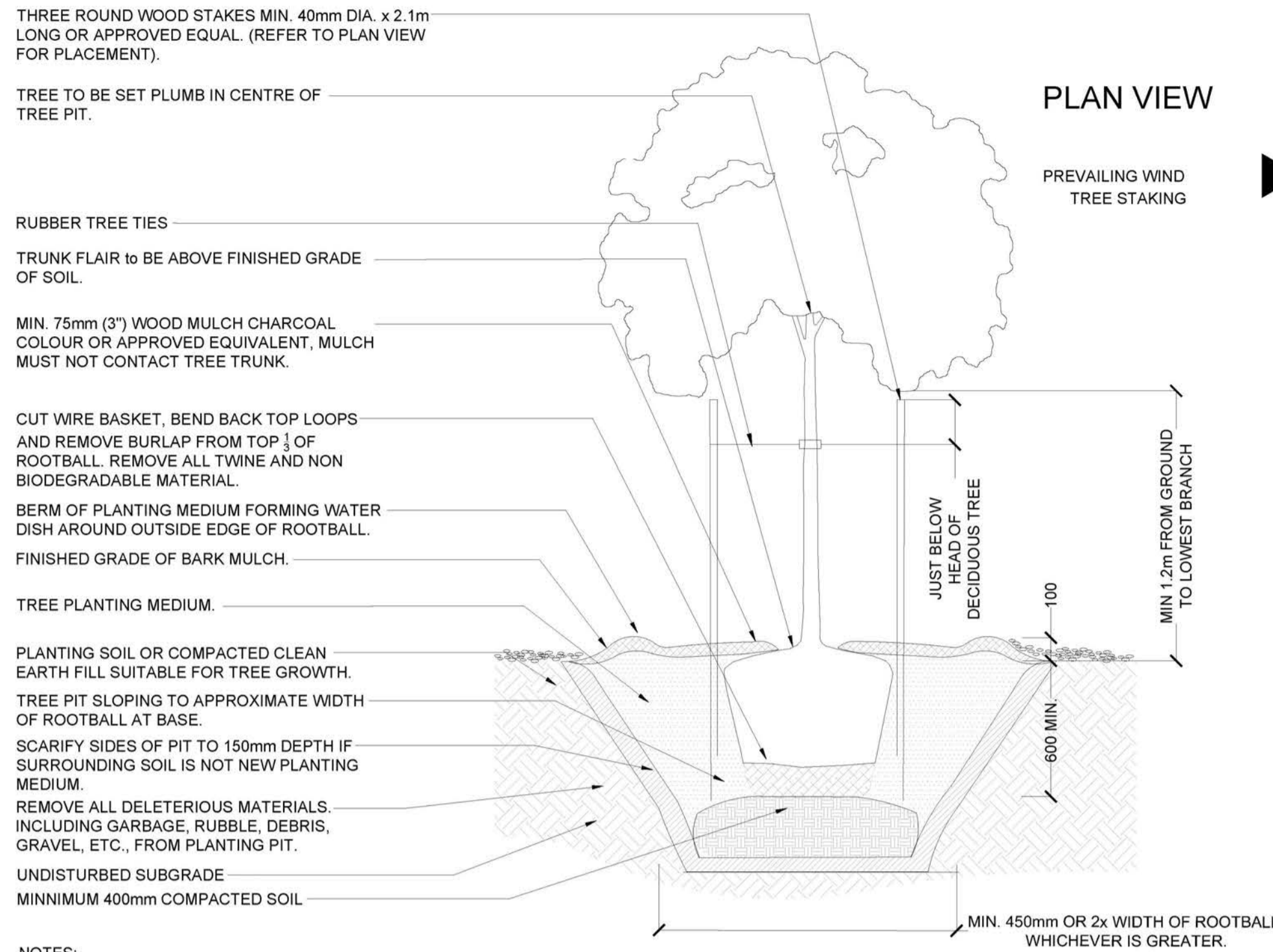

- NOTES:**
1. WATER THOROUGHLY AFTER INSTALLATION.
 2. INSTALL TREE STAKES IF REQUIRED BY CLIENT.
 3. REMOVE STAKES TWO YEARS AFTER INSTALLATION.
 4. DO NOT ALLOW AIR POCKETS TO FORM WHEN BACKFILLING.
 5. POSITION CROWN OF ROOT BALL 50mm ABOVE FINISHED GRADE TO ALLOW FOR SETTLEMENT.
 6. DEPTH OF ROOTBALL TO MATCH ORIGINAL ROOTBALL DEPTH ESTABLISHED IN THE NURSERY. ANY TREES PLANTED TOO LOW WILL BE RAISED AT THE CONTRACTOR'S EXPENSE.
 7. DO NOT DAMAGE OR CUT LEADER.
 8. IF STAKING IS DEEMED NECESSARY REFER TO TREE STAKING DETAIL.
 9. DO NOT WRAP TRUNK.
 10. ALL TREE AND SHRUB PLANTING TO MEET THE CANADIAN LANDSCAPE STANDARD SPECIFICATIONS, CURRENT EDITION.

1 TREE PLANTING DETAIL
L2.4 1:30

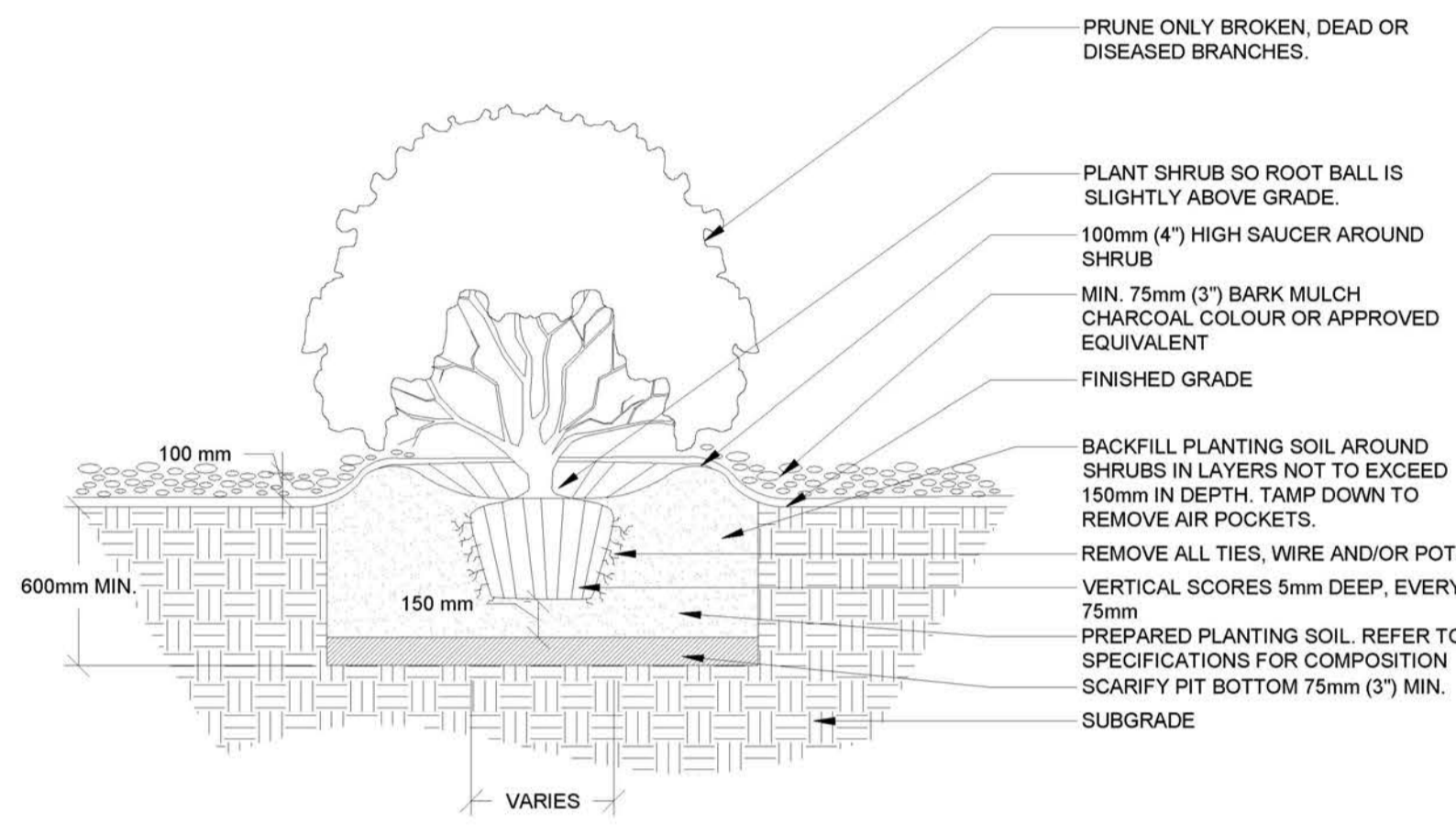

2 SHRUB PLANTING DETAIL
L2.4 1:30

LEGEND

- EXISTING/PROPOSED UNDERGROUND UTILITIES PER CIVIL
- EXISTING OVERHEAD UTILITIES PER SURVEY
- PROPOSED VEGETATION REFER TO PLANT SCHEDULE
- CONCRETE PAVING WITH MEDIUM BROOM FINISH WITH SAWCUT JOINTS APPROX. AREA: 815m² (8,772 ft²)
- PROPOSED ASPHALT PAVING PER CIVIL
- PROPOSED CONCRETE PAVING STONES - TECHNO BLOCK LINE IN PER DETAIL 1, L2 2 QTY: 235m² (2,530 ft²)
- PROPOSED COURSE CEDAR BARK MULCH NATURAL COLOUR OR 20mm ANGULAR CHARCOAL ROCK MULCH 75mm (3") DEPTH WITH TYPPAR GEOTEXTILE FABRIC APPROX. AREA: 180m² (1,940 ft²)
- FEATURE BOULDERS (5) - LOCAL STONE APPROX. 500mm HT x 1000mm L x 500mm W BURIED APPROX. 150mm DEPTH

- GENERAL NOTES:**
1. CONTRACTOR TO LOCATE AND PROTECT ALL EXISTING UTILITIES AND SERVICES, BC ONE CALL 1-800-474-6886.
 2. ALL WORK AND MATERIALS ARE TO BE IN ACCORDANCE WITH THE CURRENT EDITIONS OF THE VILLAGE OF SLOCAN CONSTRUCTION STANDARDS, AND THE MASTER MUNICIPAL CONSTRUCTION DOCUMENTS (MCCD) REQUIREMENTS.
 3. CONTRACTOR SHALL VERIFY SITE CONDITIONS PRIOR TO DEMOLITION OR CONSTRUCTION.
 4. CONTRACTOR TO VERIFY ALL DIMENSIONS AND REPORT ANY DISCREPANCIES TO ENGINEER OR LANDSCAPE ARCHITECT. PROPERTY LINES TO BE VERIFIED PRIOR TO CONSTRUCTION.
 5. CONTRACTOR IS RESPONSIBLE TO COORDINATE THE STAGING OF CONSTRUCTION ACTIVITIES AND WORK WITH ALL OTHER CONTRACTORS ONSITE, INCLUDING IRRIGATION SLEEVING AND WEEPING TILE DOWNPOUT LOCATIONS PRIOR TO HARDSCAPE INSTALLATION.
 6. THE LANDSCAPE ARCHITECT WILL BE NOTIFIED MIN. 48 HOURS PRIOR TO COMMENCEMENT OF WORK.
 7. THE QUANTITIES LISTED ARE ESTIMATES. CONTRACTOR TO VERIFY ALL QUANTITIES THROUGH SITE SURVEY AND REPORT ANY DISCREPANCIES TO ENGINEER OR LANDSCAPE ARCHITECT.
 8. ANY CHANGES OR ALTERATIONS TO DRAWINGS SHALL BE APPROVED BY LANDSCAPE ARCHITECT.
 9. CONTRACTOR TO CONFIRM ELEVATION, LOCATION, AND GRADIENT OF SURROUNDING GRADES AND PROVIDE A SMOOTH TRANSITION.
 10. CONTRACTOR TO BE REGISTERED WITH WORKSAFE BC.

- PLANTING NOTES:**
1. REFER TO PLANT SCHEDULE FOR DETAILED SPECIES INFORMATION L1.2. NO PLANT SUBSTITUTIONS ARE PERMITTED WITHOUT WRITTEN APPROVAL BY LANDSCAPE ARCHITECT.
 2. CONFINE EQUIPMENT AND WORKERS TO LIMIT OF DISTURBANCE WITHIN PHASE I BOUNDARY.
 3. TURF TO BE PLANTED ADJACENT TO DISTURBED AREAS AND OTHER AREAS OF NEW CONSTRUCTION.
 4. PLANT MATERIAL SHALL MEET ALL REQUIREMENTS OF THE LATEST EDITION OF THE CANADIAN NURSERY TRADES ASSOCIATION GUIDE SPECIFICATIONS FOR NURSERY STOCK UNLESS OTHERWISE SPECIFIED.
 5. SUPPLY 75mm OF NATURAL COLOUR CEDAR BARK MULCH OR ANGULAR ROCK MULCH TO ALL PROPOSED TREE AND SHRUB BEDS.
 6. INSTALL 600-1000mm MIN. DEPTH TOPSOIL IN PLANTING AREAS.
 7. TREES AND SHRUBS TO BE GUARANTEED FOR 2 GROWING SEASONS BY CONTRACTOR. ALL REPLACEMENTS TO BE AT CONTRACTOR'S EXPENSE. SUBSTITUTIONS TO BE APPROVED BY LANDSCAPE ARCHITECT.

- TOPSOIL NOTES:**
1. GROWING MEDIUM FOR ALL TREE, SHRUB, AND WILDFLOWER BEDS IS TO MEET THE CANADIAN LANDSCAPE SPECIFICATION UNDER THE DESIGNATION 2P.
 2. GROWING MEDIUM SHOULD BE CERTIFIED TO ITS ORIGIN AND VIRTUALLY FREE OF INVASIVE PLANT SEEDS, THEIR REPRODUCTIVE PARTS AND ROOTS, BUILDING MATERIALS, INVASIVE OR NOXIOUS PLANTS, NON-COMPOSTED WOOD, WOOD WASTE, INSECT PESTS, PLANT PATHOGENIC ORGANISMS, CHEMICAL POLLUTANTS OR SUBSTANCES AT LEVELS TOXIC TO PLANTS, AND OTHER EXTRANEUS MATERIALS THAT DETRACT FROM DESIRABLE PHYSICAL AND CHEMICAL PROPERTIES REQUIRED FOR LANDSCAPING PURPOSES.
- LOAM: NATURAL, FERTILE, FRIABLE, AGRICULTURAL SOIL MEETING FOLLOWING REQUIREMENTS:
- NOT LESS THAN 6% ORGANIC MATERIAL.
 - PH VALUE RANGING FROM 5.9 TO 7.0.
 - NON-TOXIC TO PLANT GROWTH.
 - E.C. SALINITY READING NOT EXCEEDING 1.5.
 - SOIL TEXTURE: LOAM SOIL AS DEFINED BY CANADIAN SYSTEM OF SOIL CLASSIFICATION.
- PEAT MOSS: DECOMPOSED PLANT MATERIAL, FAIRLY ELASTIC AND HOMOGENEOUS, FREE OF DECOMPOSED COLLOIDAL RESIDUE, WOOD, SULPHUR, AND IRON. MINIMUM OF 80% ORGANIC MATTER BY MASS; PH VALUE BETWEEN 4.5 AND 6.0.

PROJECT:
HAROLD STREET NORTH RECONSTRUCTION

LOCATION:
SLOCAN, BC

LEGAL DESCRIPTION:
LOT A, PLAN NEP20184



CLIENT:
VILLAGE OF SLOCAN
T: 250.355.2277
E: admin@villageofslocan.ca

LANDSCAPE ARCHITECT BCSLA 563



GOLDEN, BC 250.938.7337



CIVIL ENGINEER:
LAWSON ENGINEERING LTD.

825C LAKESHORE DRIVE W
PO BOX 106 SALMON ARM, BC V1E 4N2
T: 250.832-3220

NOTE: ORIGINAL SIZE ANSI D (22x34")

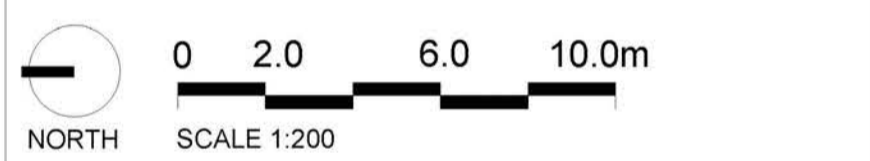

ISSUED FOR: TENDER

DATE: 2026-03-16

NOT FOR CONSTRUCTION

NO.	DESCRIPTION	DATE	BY
1.	PRELIMINARY DESIGN	2022-10-27	JJ
2.	50% REVIEW	2022-11-09	JJ
3.	75% REVIEW	2022-12-05	JJ
4.	100% REVIEW	2023-01-31	JJ
5.	ISSUED FOR TENDER	2023-02-15	JJ
6.	RE-ISSUED FOR TENDER REVIEW	2025-12-11	JJ
7.	ISSUED FOR TENDER	2026-03-16	JJ

DESIGNED BY: JJ

DRAWING TITLE :
LANDSCAPE DETAILS

L-2.4